



TECHNISCHE
UNIVERSITÄT
WIEN
Vienna | Austria

FWF Der Wissenschaftsfonds.

Project N° I3148-G27

The Viennese building stock 1920 to 2018

Ulrich KRAL & Ferdinand REIMER

Workshop “Towards a knowledge base for material reserves and resources in buildings & infrastructures”
29-30 October 2018, Odense, Denmark.

EU recycling target for C&D waste 70% by 2020

C&D waste generation Vienna

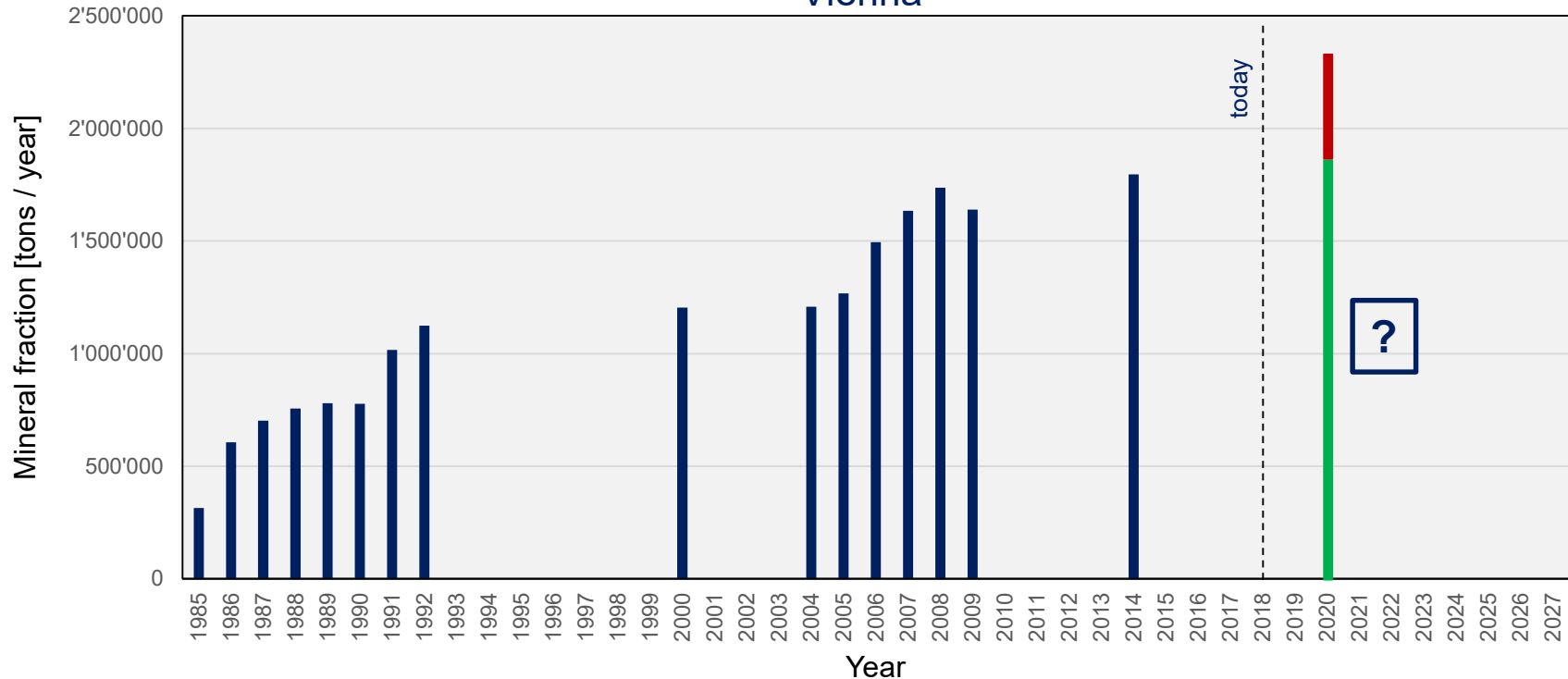

Data sources

MA22 (2016). Abfallmengen nach Wiener Erzeuger 2004 bis 2009.

MA22 (2016). Abfallmengen nach Wiener Erzeuger 2009. Wien.

MA22 (2011). Abfallstatistik Wien 2008. K. Kellner. Wien.

UBA (2016). Abfallanfall in Wien für das Jahr 2014 nach Schlüsselnummer (ohne kommunale Abfälle). Wien.

Ableidinger, M., K. Arbter, W. Hauer, S. Sciri and U. Volk (2007). Wiener Abfallwirtschaftskonzept 2007: Ist-Zustand der Wiener Abfallwirtschaft.

Sündermann, G. (1994). Verwertungsmöglichkeiten für Hochbaurestmassen Thesis, Wien, Techn. Univ., Dipl.-Arb., 1995.

Predicting C&D waste & recyclables

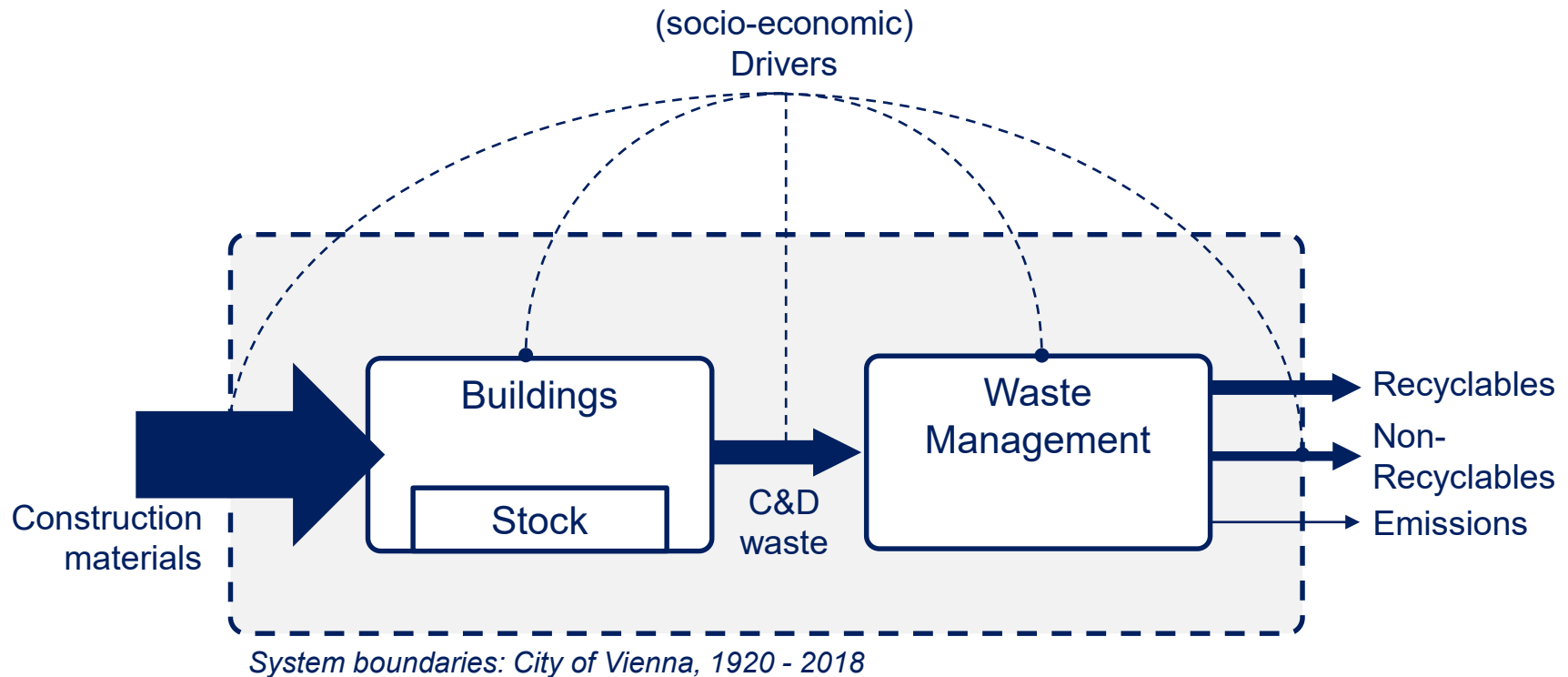

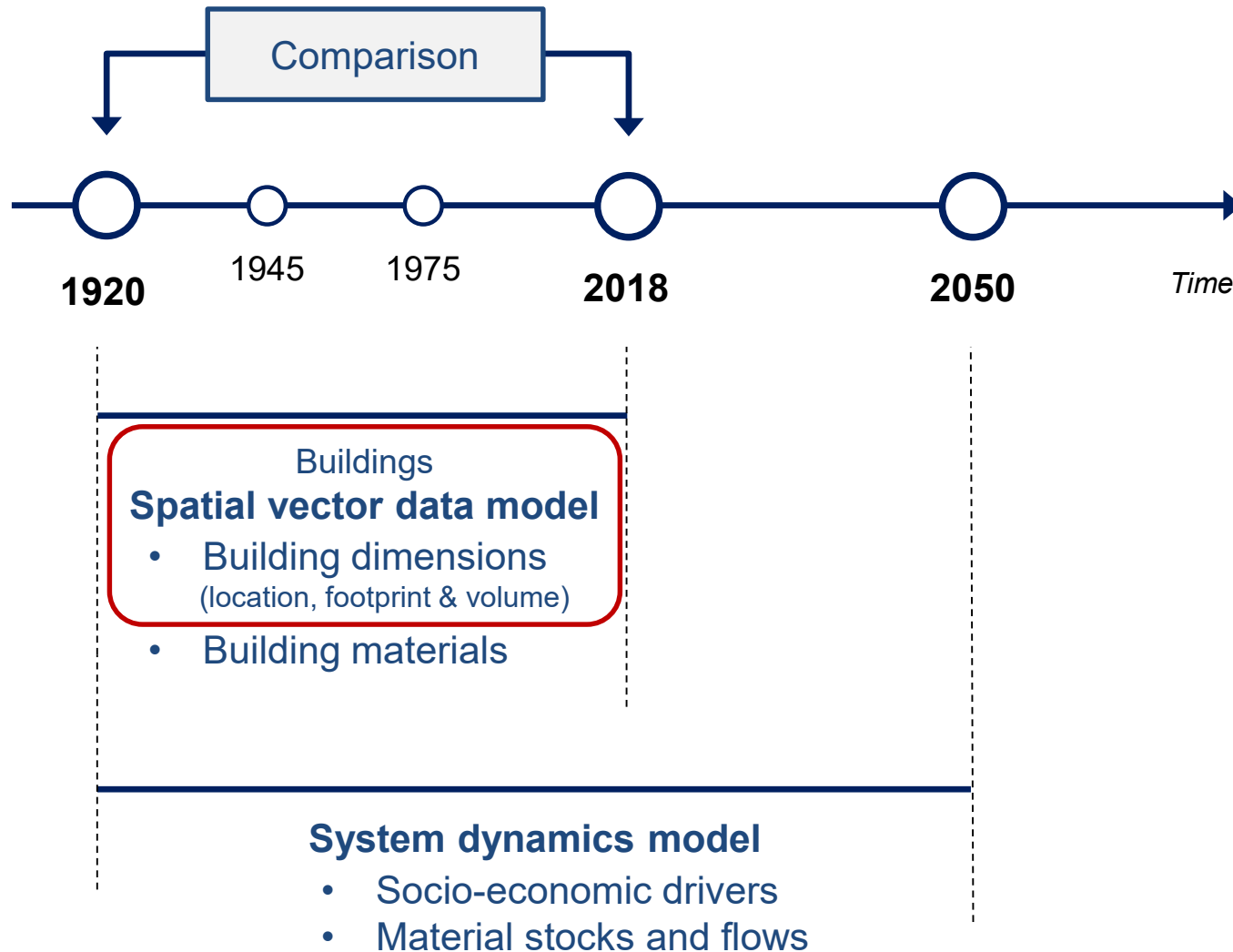

Geographische Datenmodelle

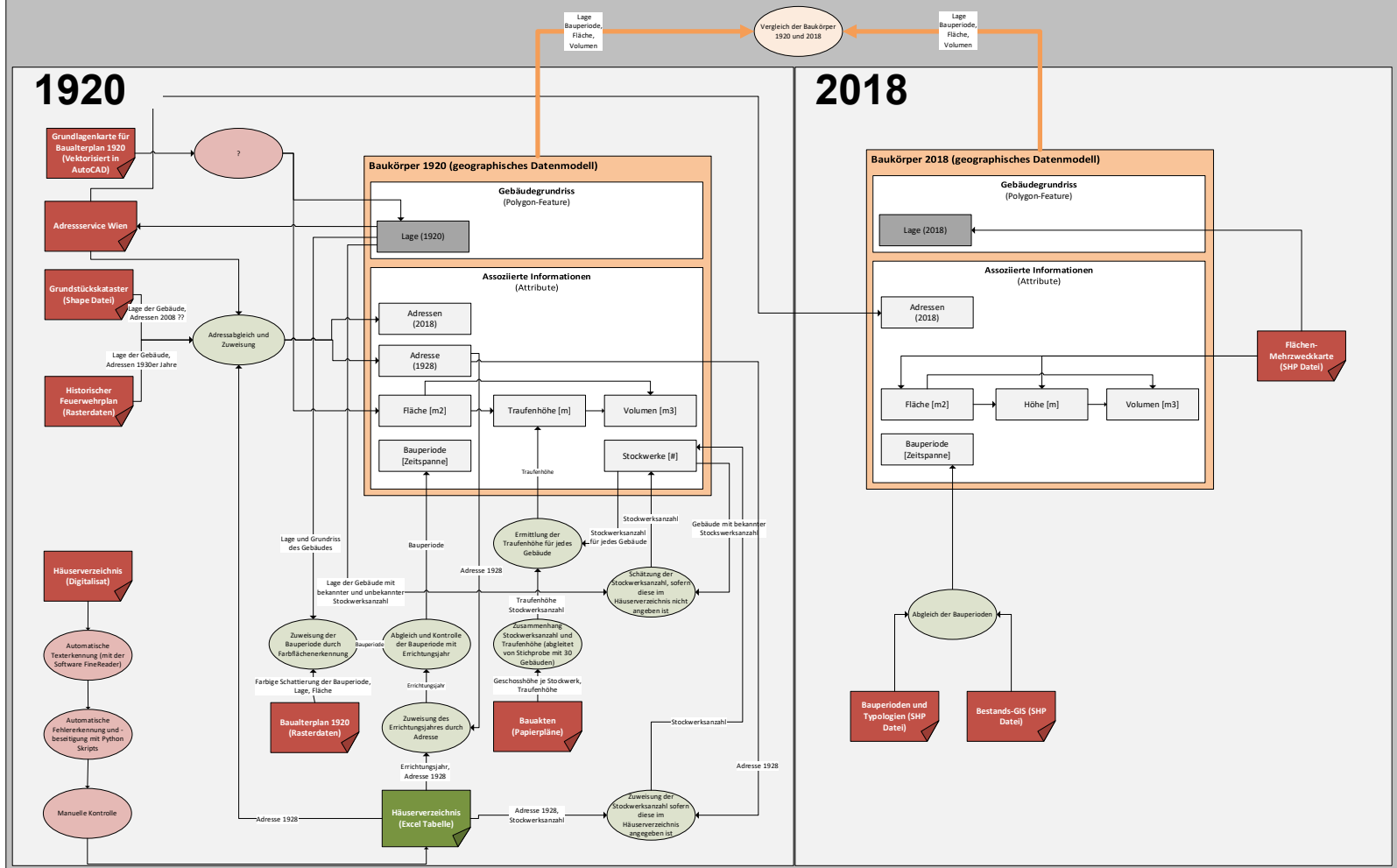

Processing historical data

Raw data

Building statistic,
addresses 1928

City map
1920

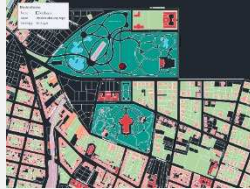

Construction
Plans < 1920

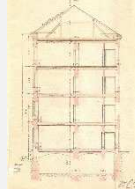

Building periods
1920



Fire brigade
map 1930



Addresses
2018



Preparing raw data

Machine readable data

Building statistic,
addresses 1928

City map
1920

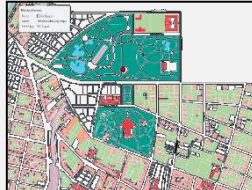

Story heights

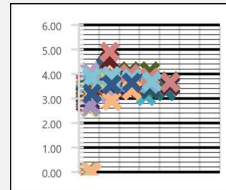

Building periods
1920



Fire brigade
map 1930

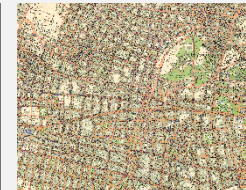

Addresses
2018



Linking machine readable data

Spatial vector data model 1920

Temporal-spatial comparison

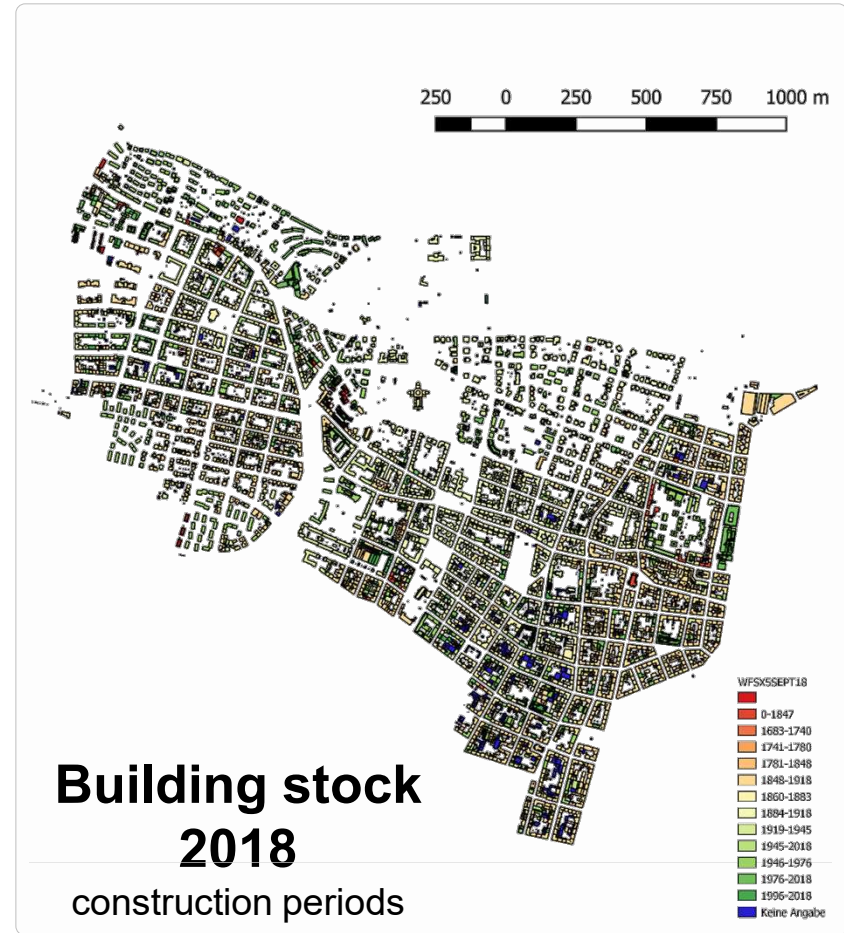
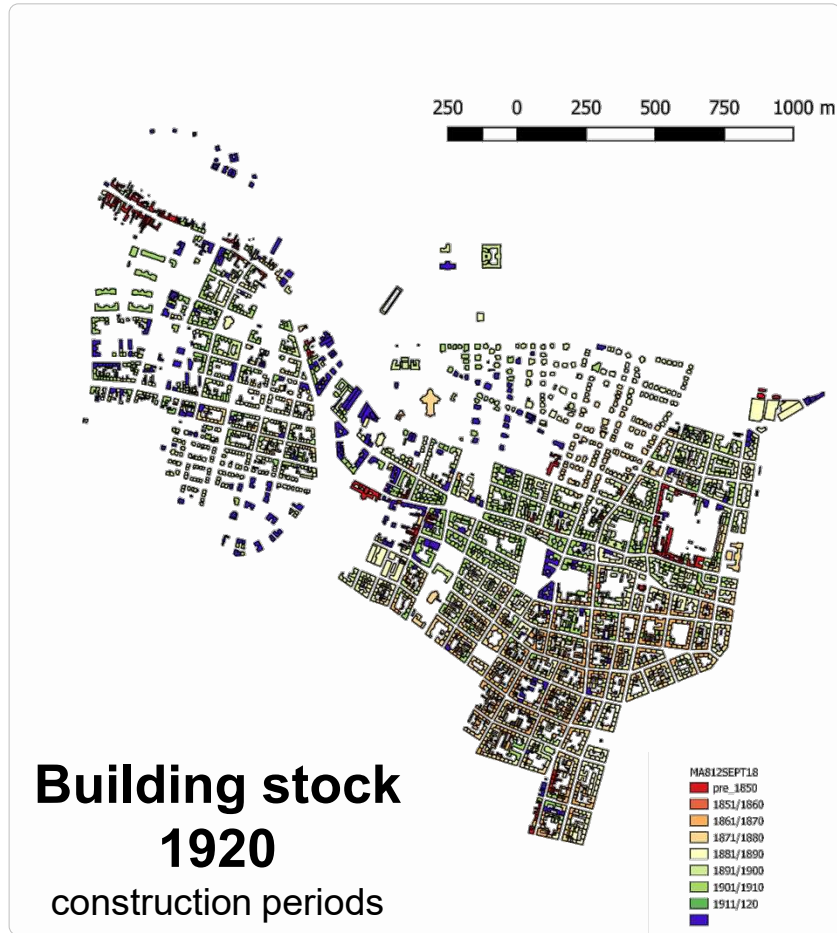

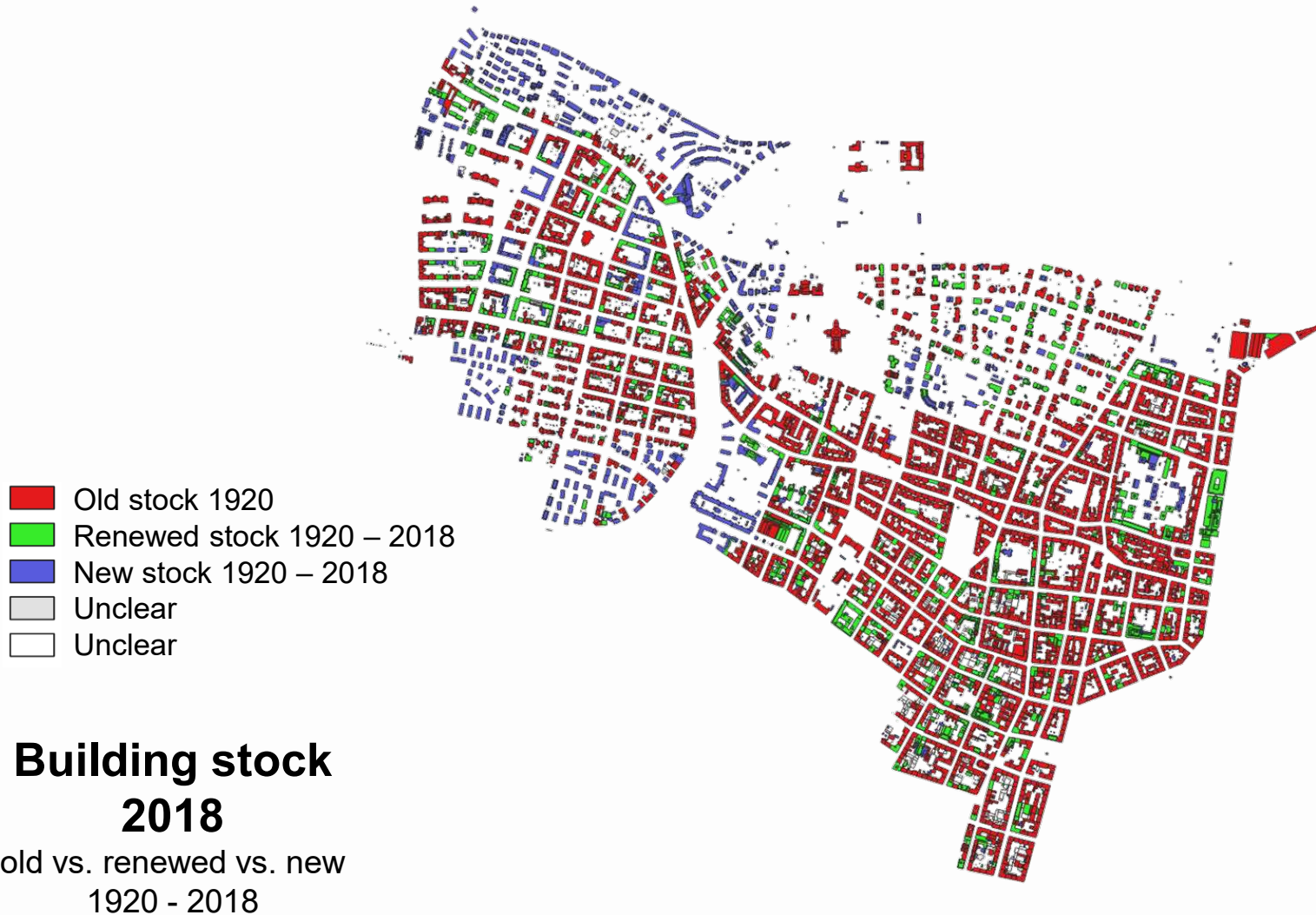

Building stock 1920-2018

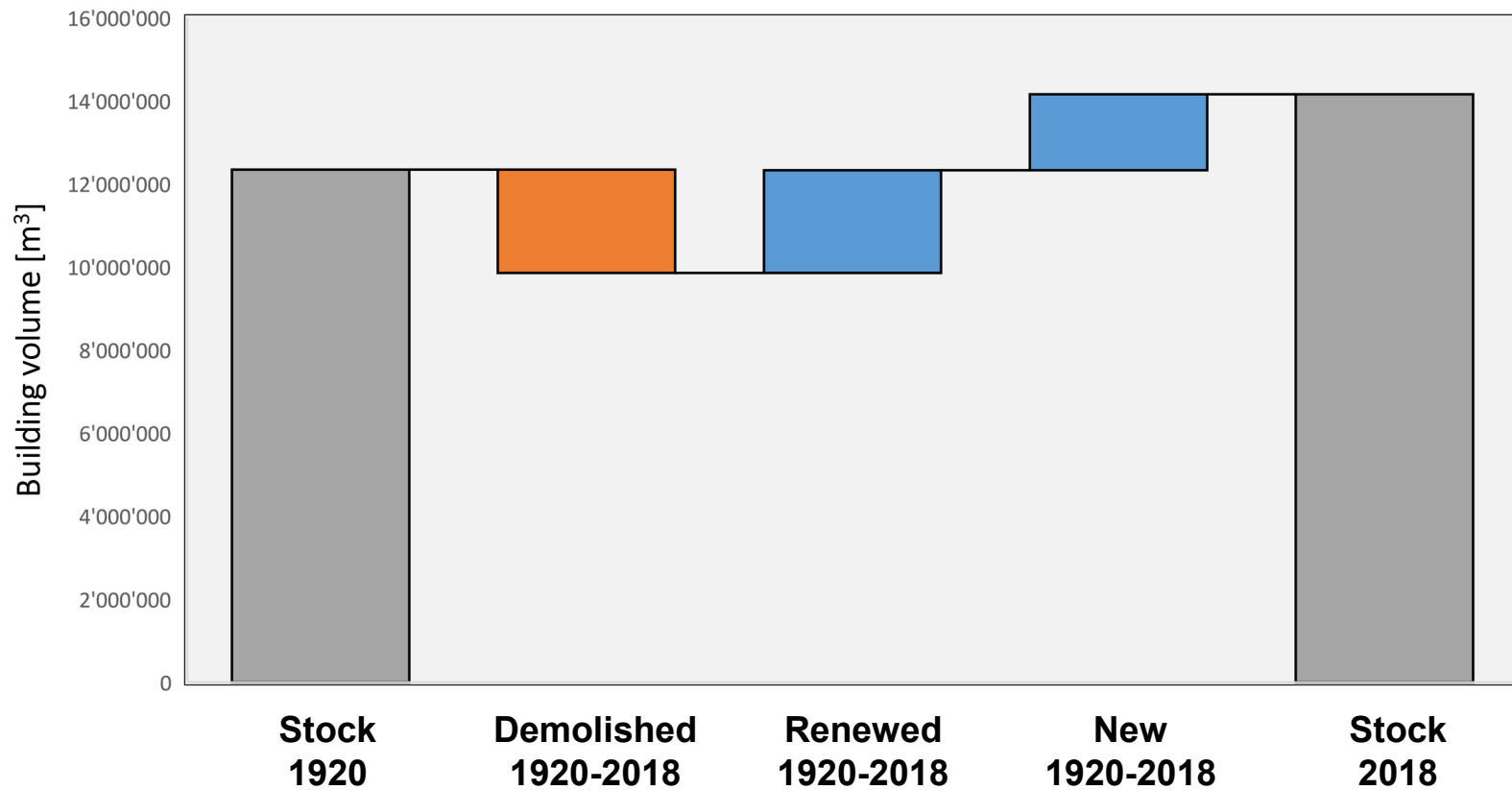

Building stocks per construction period based on building footprint [m²]

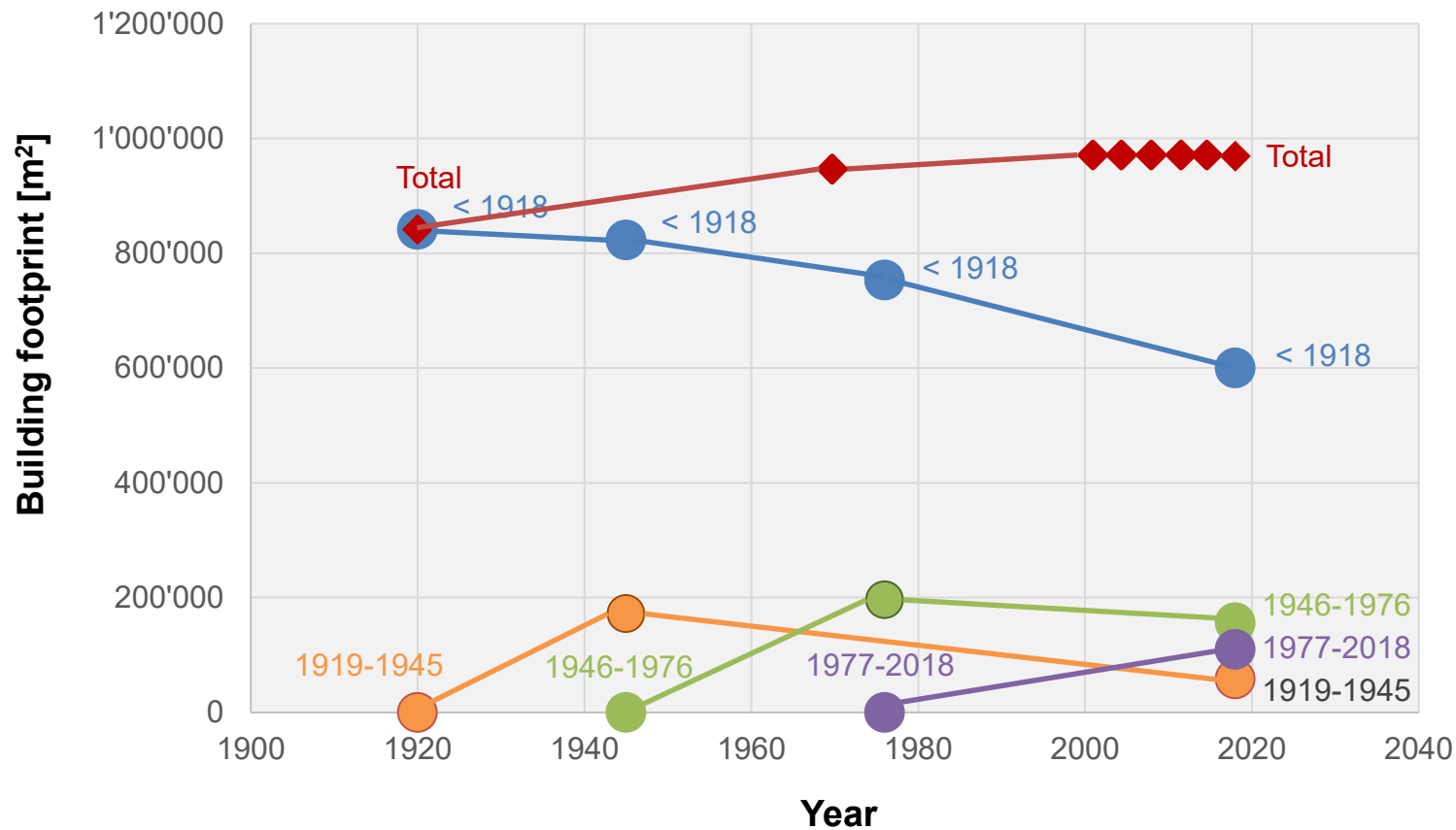

Demolition rates per construction period

based on building footprint [m²]

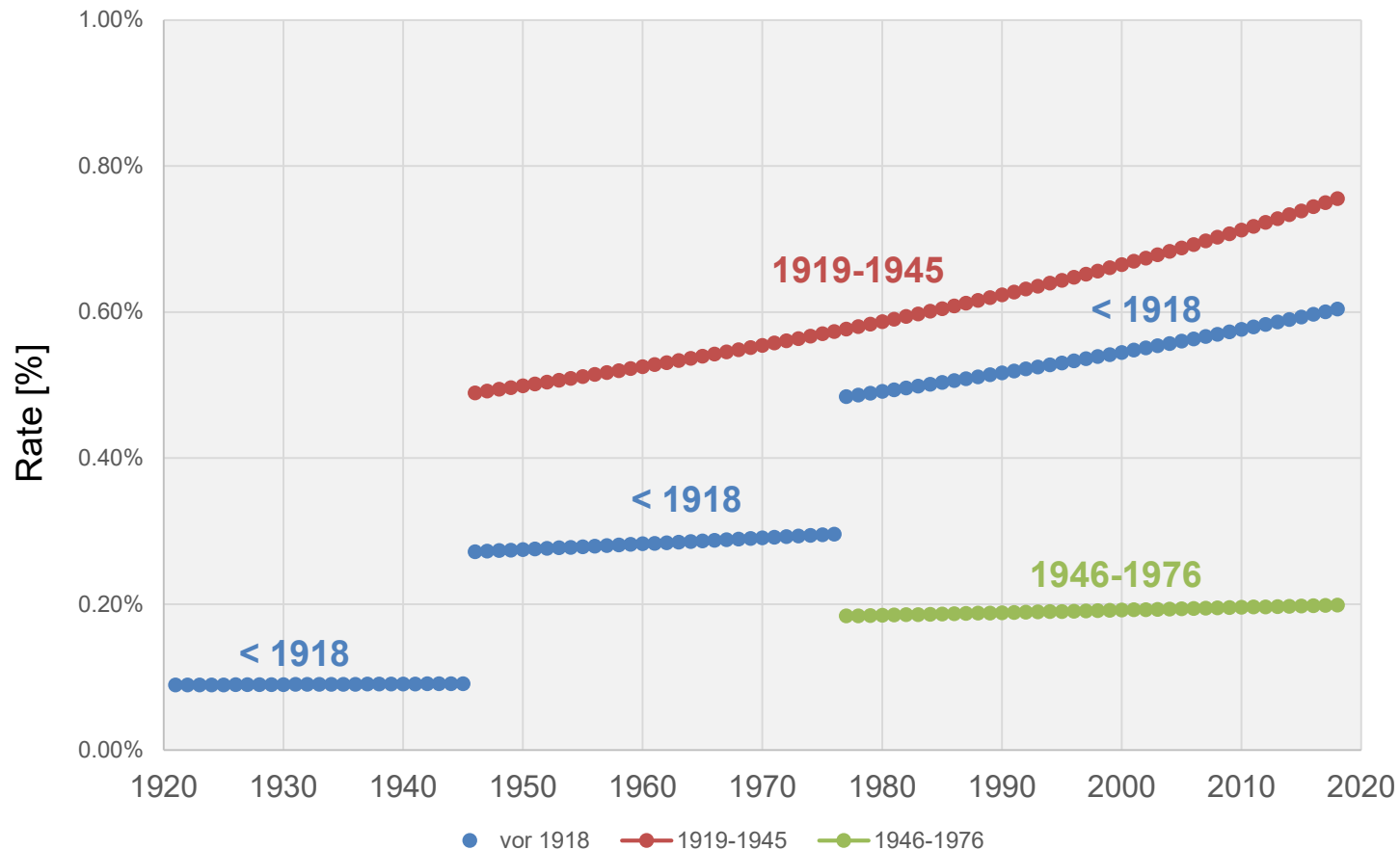

building attribute “construction period” for the building volume 2018

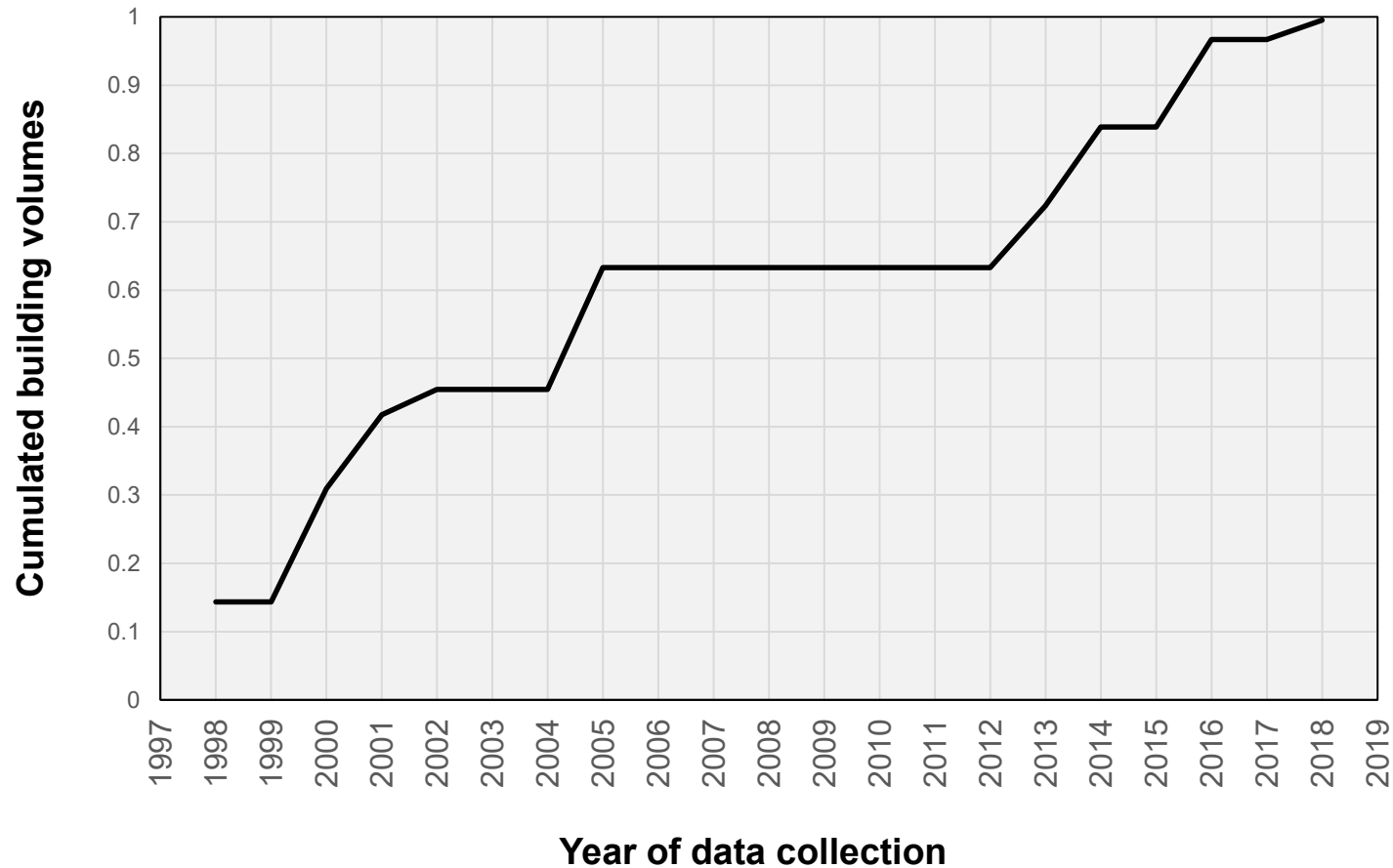

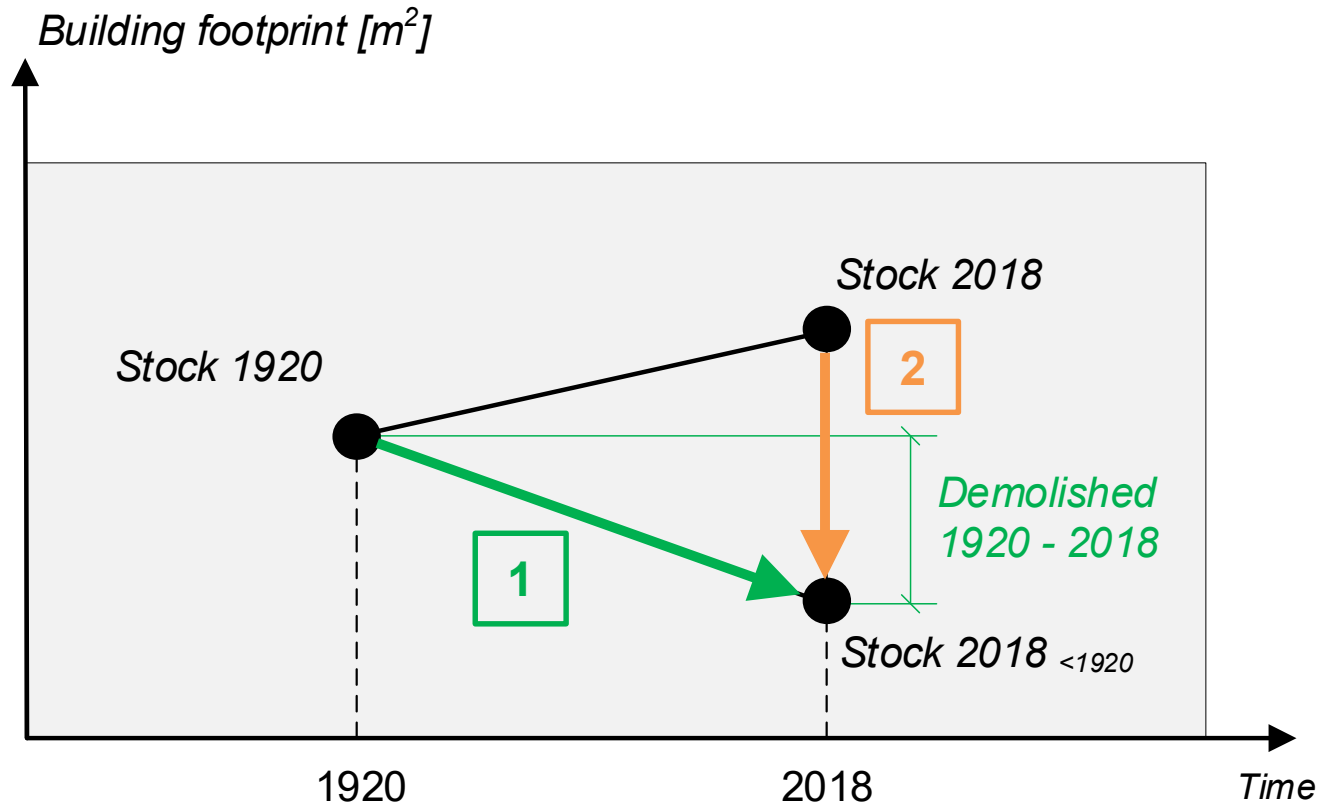

Plausibility - Results

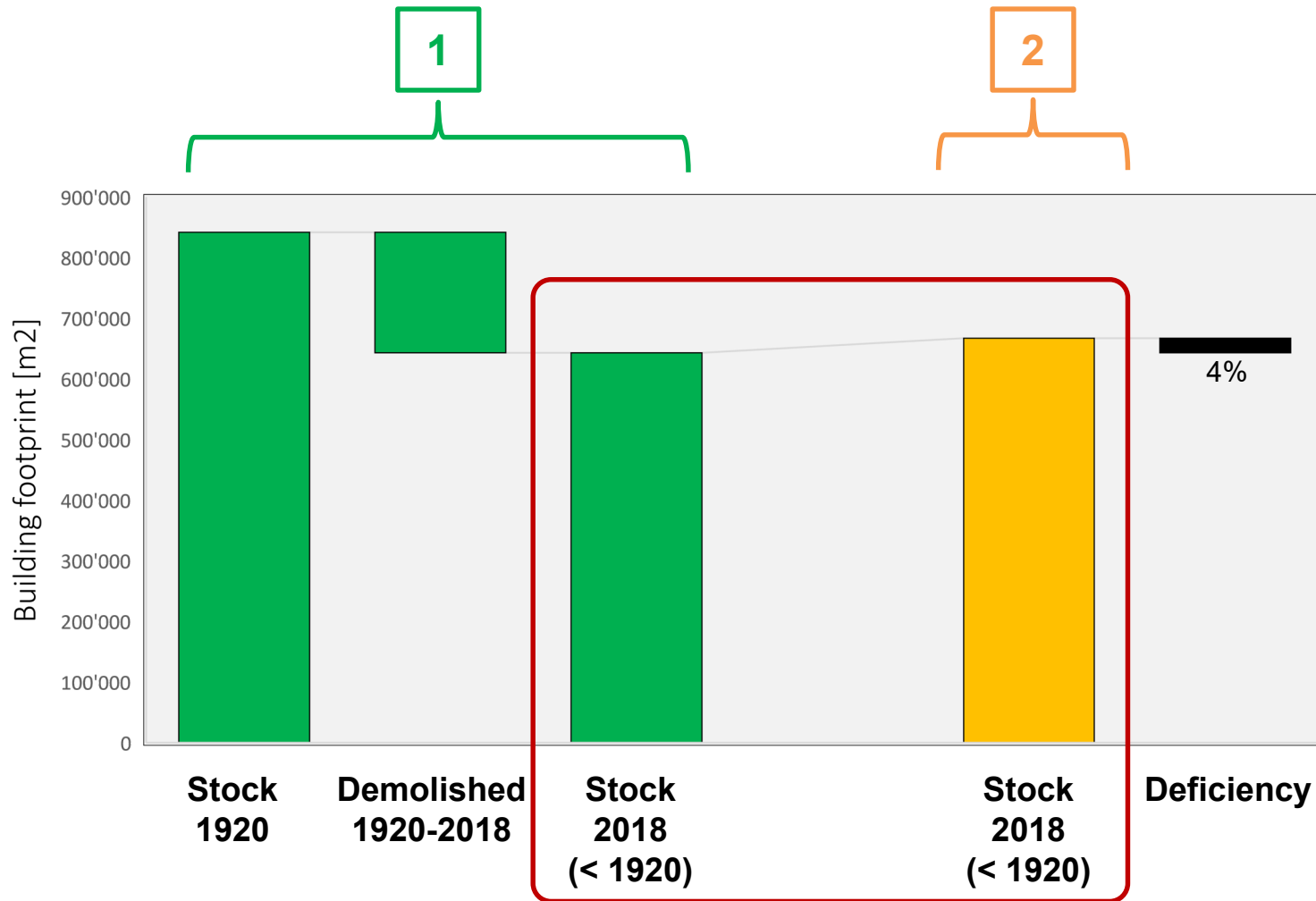

What comes next

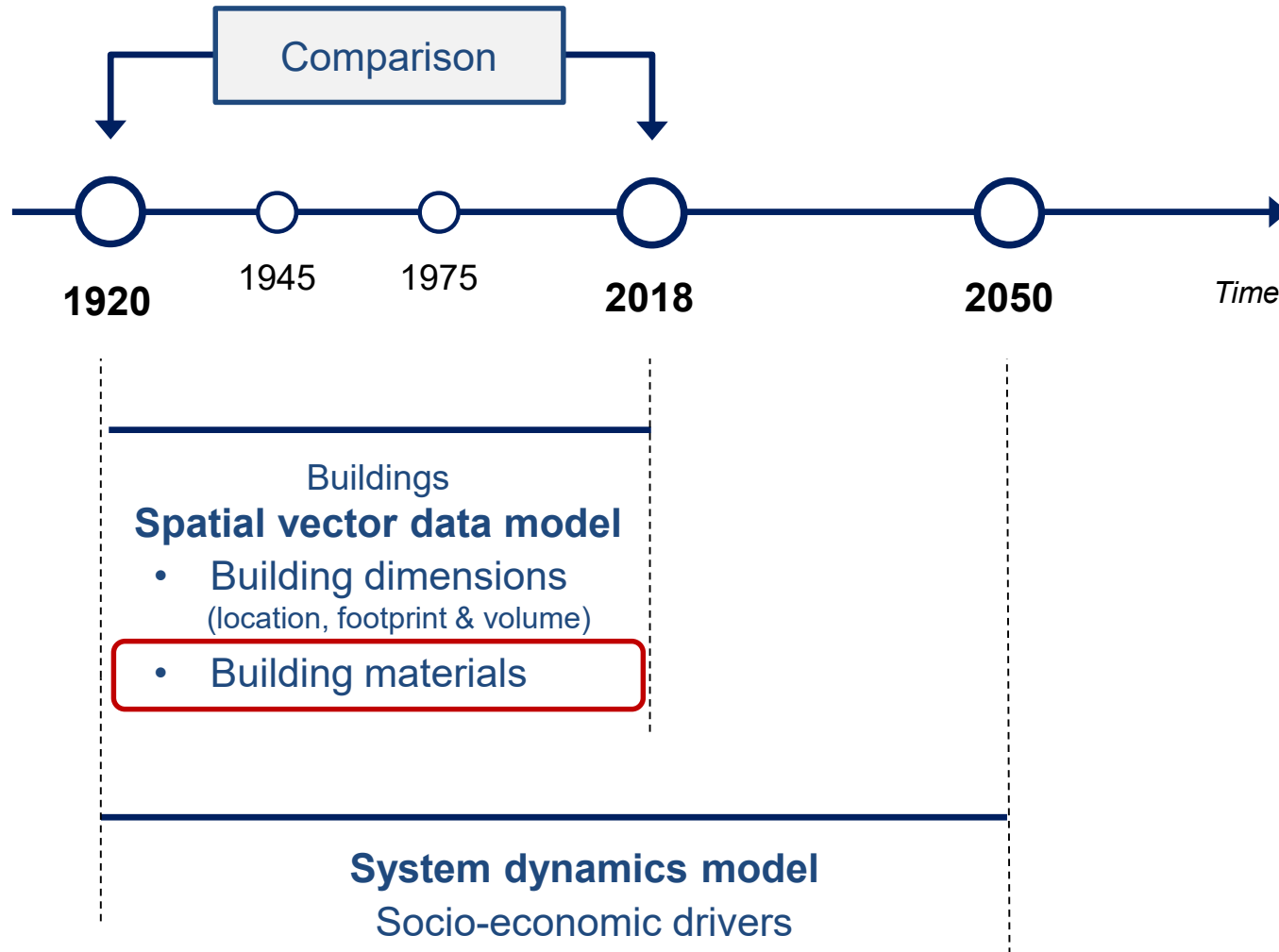

N° Buildings

Building period	Commercial	Industry	Residential	Total
-1918	9	3	20	32
1919-1945	3	2	13	18
1946-1976	5	1	31	37
1977-1996	2	1	11	14
1996-	3		13	16
Total	22	7	90	117

Established by Kleemann, F., Lederer, J., Rechberger, H. and Fellner, J. (2017). GIS-based Analysis of Vienna's Material Stock in Buildings. Journal of Industrial Ecology. 21(2): p. 368-380.

Extended by U. Kral & F. Reimer

- Extending the database
- Establishing a community-wide, open access database?
(machine-readable, primary data)

Thank you

Ulrich Kral

Technische Universität Wien
Karlsplatz 13/226
1040 Vienna, Austria

Tel.: ulrich.kral@tuwien.ac.at
Tel.: +4315880122655

Ferdinand Reimer

Technische Universität Wien
Karlsplatz 13/226
1040 Vienna, Austria

Tel.: ferdinand.reimer@tuwien.ac.at
Tel.: +4315880122669