



Quantifying and characterizing the Finnish building stock

Satu Huuhka
satu.huuhka@tut.fi
+358-50-3009263

Background

- PhD study taken place 2012 – 2016
 - Now in pre-examination phase
- Bundle dissertation based on the following articles:
 - Huuhka & Lahdensivu (2016) Statistical and geographical study on demolished buildings *BRI*
 - Huuhka (2015) Vacant residential buildings as potential reserves *BRI*
 - Huuhka, Kaasalainen, Hakanen & Lahdensivu (2015) Reusing concrete panels from buildings for building: Potential in Finnish 1970s mass housing *ResConRec*
 - Kaasalainen & Huuhka (2016) Homogenous homes of Finland: 'Standard' flats in non-standardized blocks *BRI*



Research objects

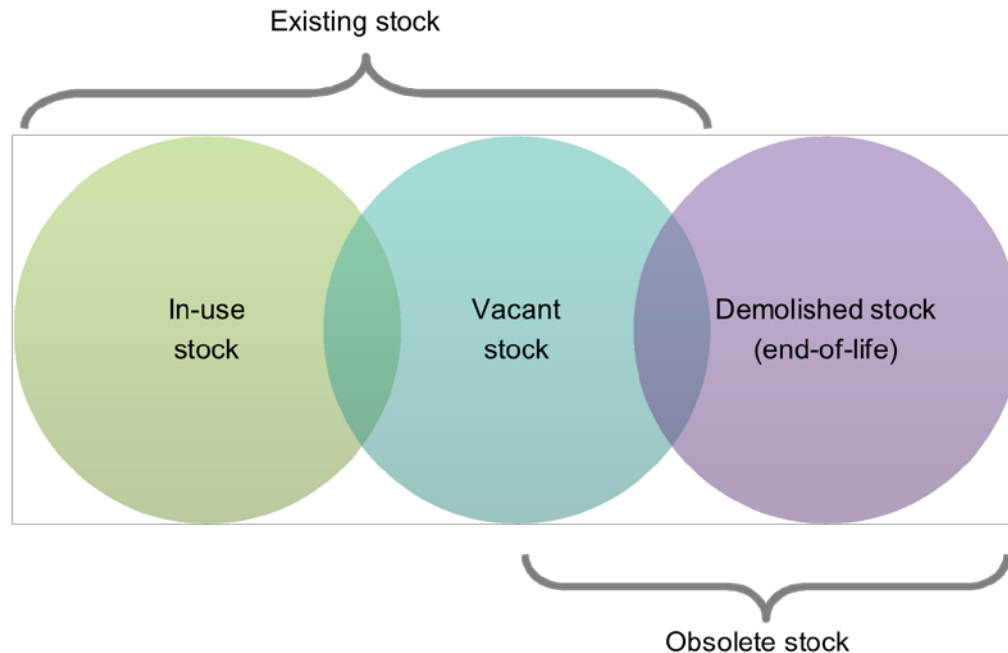

Figure 2. Conceptualization of the composition of the building stock and the relations between different parts thereof.



Research objects

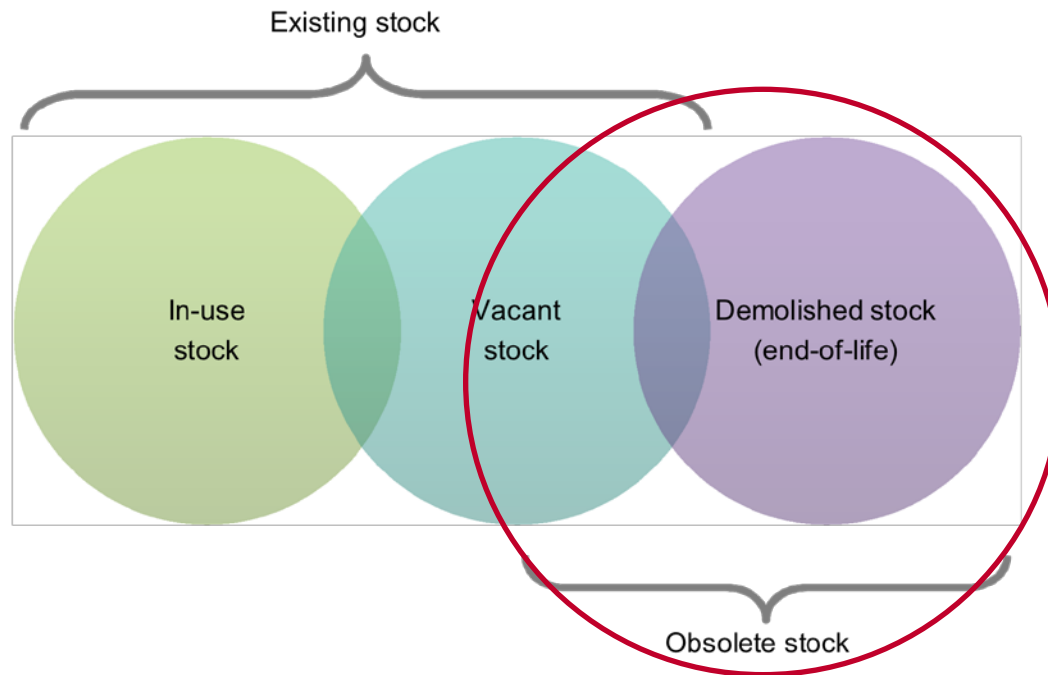

Figure 2. Conceptualization of the composition of the building stock and the relations between different parts thereof.



Background

- PhD study taken place 2012 – 2016
 - Now in pre-examination phase
- Bundle dissertation based on the following articles:
 - Huuhka & Lahdensivu (2016) Statistical and geographical study on demolished buildings *BRI*
 - Huuhka (2015) Vacant residential buildings as potential reserves *BRI*
 - Huuhka, Kaasalainen, Hakanen & Lahdensivu (2015) Reusing concrete panels from buildings for building: Potential in Finnish 1970s mass housing *ResConRec*
 - Kaasalainen & Huuhka (2016) Homogenous homes of Finland: 'Standard' flats in non-standardized blocks *BRI*

Top-
down



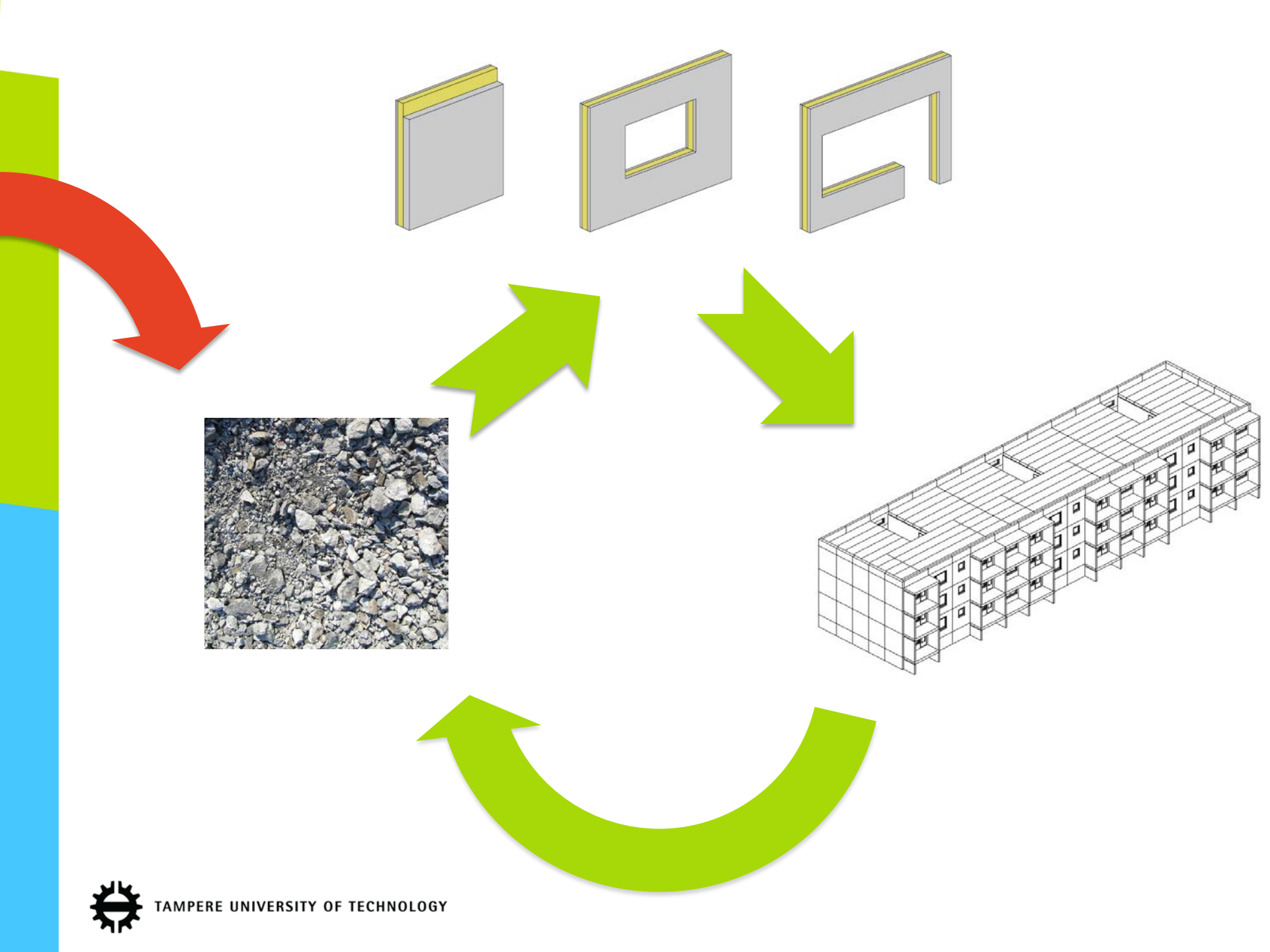

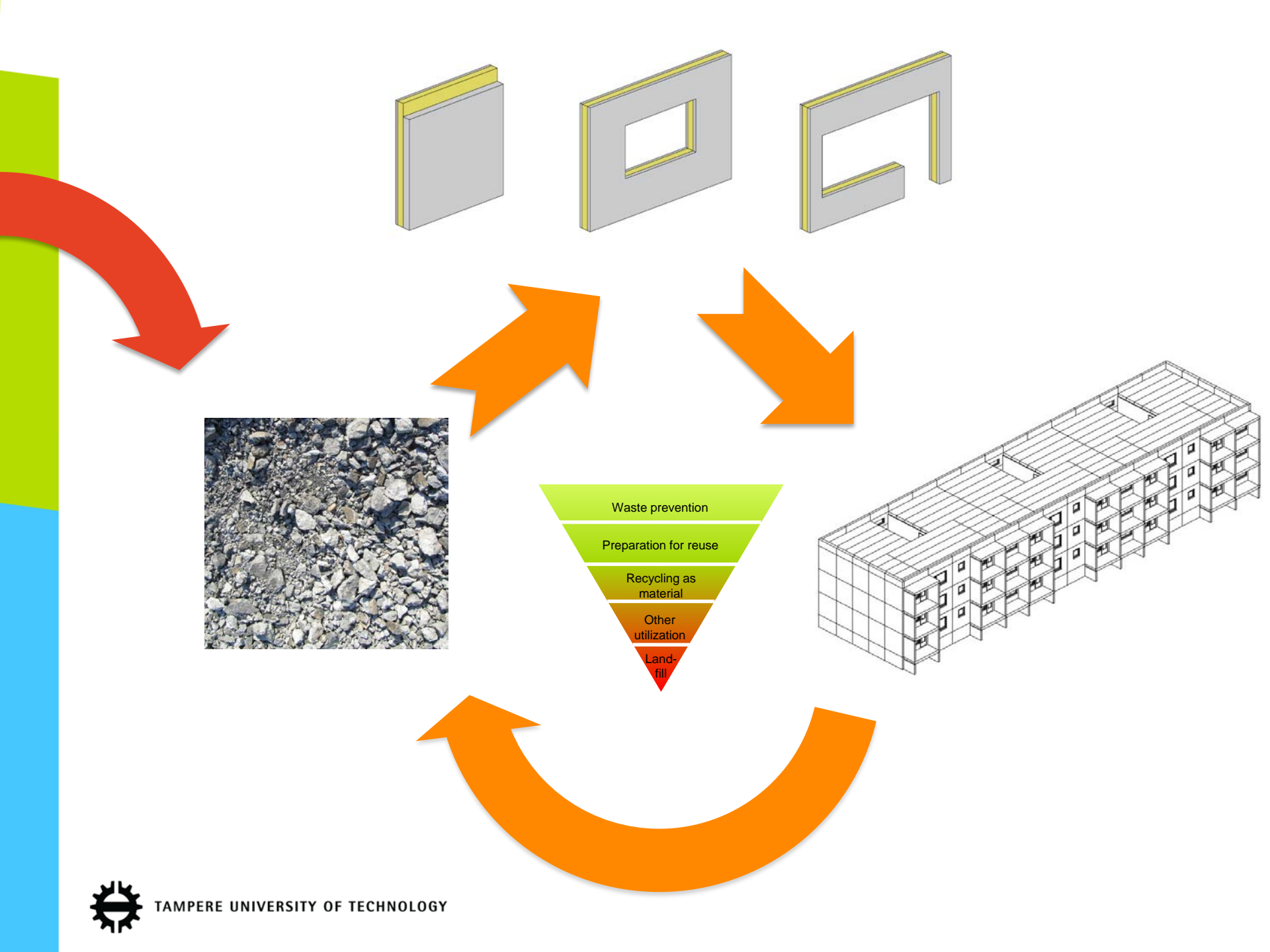

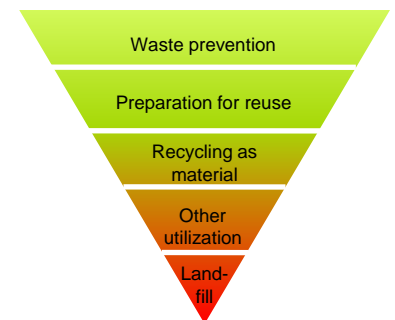
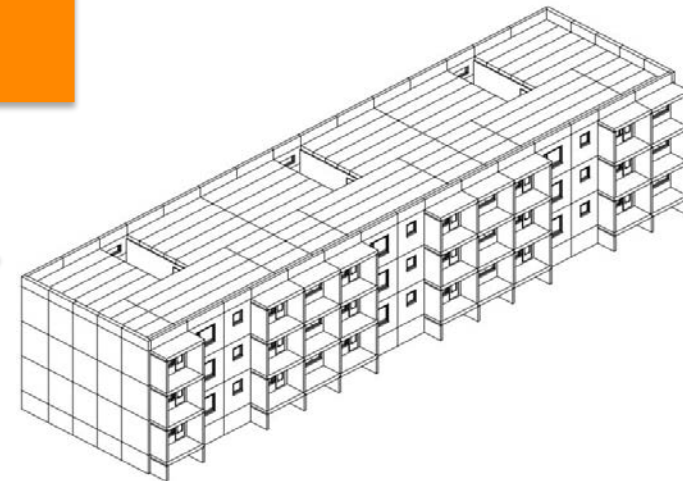
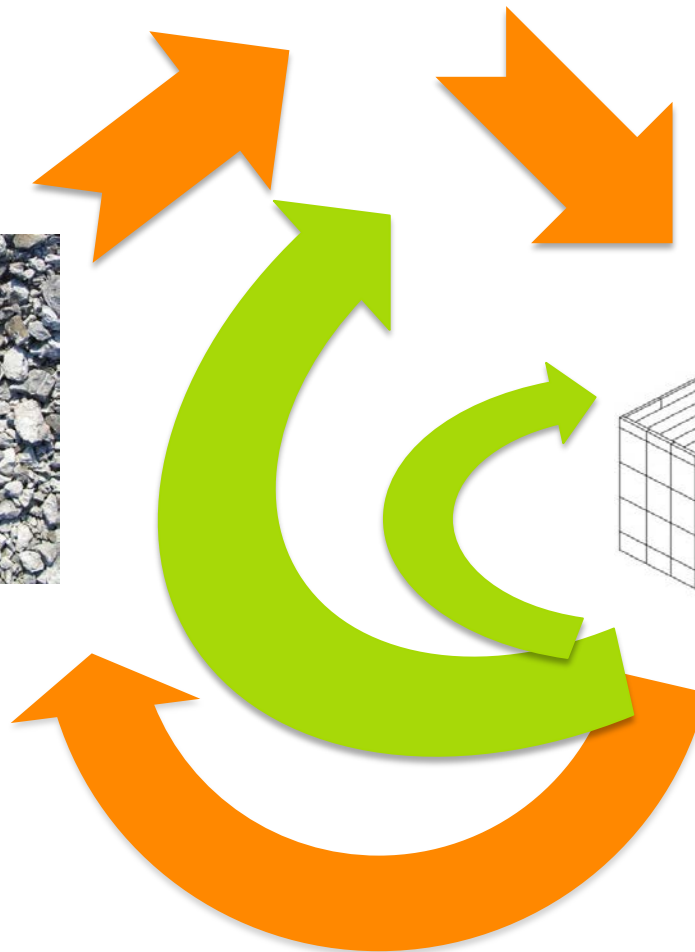
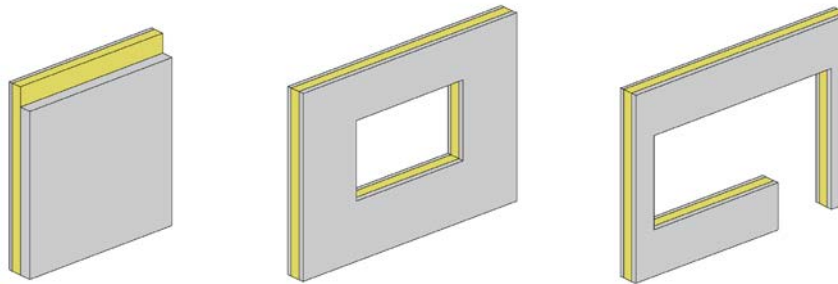

Background

- PhD study taken place 2012 – 2016
 - Now in pre-examination phase
- Bundle dissertation based on the following articles:
 - Huuhka & Lahdensivu (2016) Statistical and geographical study on demolished buildings *BRI*
 - Huuhka (2015) Vacant residential buildings as potential reserves *BRI*
 - Huuhka, Kaasalainen, Hakanen & Lahdensivu (2015) Reusing concrete panels from buildings for building: Potential in Finnish 1970s mass housing *ResConRec*
 - Kaasalainen & Huuhka (2016) Homogenous homes of Finland: 'Standard' flats in non-standardized blocks *BRI*

Top-down

Bottom-up



Finnish Building and Dwelling Register (BDR)

– Established 1980

- Part of the Population Information System
- Includes both residential and non-residential buildings
- Pre-1980 buildings recorded based on owner surveys
- Since 1980 buildings recorded by building inspection authorities based on building and demolition permits
- Buildings are retained in the registry even after demolition



Original format = excel table

Excel Arkisto Muokkaus Näytä Lisää Muotoile Työkalut Tiedot Ikkuna Ohjeet

A2 fx 00440200020022V001

Tulokset 20130422 PURETUT.xlsx

Uusi Avaa Tallenna Tulosta Tuo Kopioi Sijoita Muotoile Peru Tee uudelleen Summa Lajittele A-Z Lajittele Z-A Valikoima Työkaluryh... Zoomaa Ohje

Courier New 9 B I U % 0 00 0

	A	B	C	D	E	F	G	H	I	J	K	L	M	N	O	P	Q	R	S	T	U	V
	rakennustunnus	vyöhyke	pkoordinaatti	koordinaatti	koordvarmuus	karttalehti	osa_alue	aanesistysalue	muu_tunniste	kiint_nimi	maara_ala_on	valmistusajav	kaava	hallintaperuste	julkimateria	kerrosala	kerrosaluku	kokoaala	tilavuus	kellariaala	kayttotila	kayttotilavuus
1	00440200020022V001		7029727	288085	B		101001	005		Vuori	19640000	1	183			32	1	183			06	200807
2	00440300070230X001		7020809	291868	2		202009	004		Rintavainio	19480000	1				56	1				06	200111
3	00440400030144X001		7024203	288617	5		101005	005		Uustalo	19730000	1				28	1				07	200208
4	00440400040024X001		7024517	290959	2		101005	005		Kujanperä	19550000	1				593	1	593	2450		08	200212
5	00441300030063R002		7020753	281477			202007	004		Saarela	19920801	5	1	1		92	1				06	201203
6	005401000100146001		6987113	345390	A		204007	006		Saarelanmäki	19660000					70	1				06	200102
7	00540100010148H001		6991905	339624			205011	006		Harju	19200000							34			07	201009
8	00540100020138H001		6992080	340280	A			003		Takala	19900000							105			07	200309
9	00540100020197N001		6988197	343338	B			006		Rantaniemi	19400000							15			07	200309
10	00540100020197N002		6988282	343240				006		Rantaniemi	19400000										07	200309
11	00540100020254H001		6992053	340322			205011	003		Saarenvainio	19390000										07	200311
12	00540100030417N002		6987018	341024	6		105025	002		Jonnala	20030612	2	1	5		130	1	130	400		08	201209
13	005401001201277001		6996936	340780			206015	004		Rantala	19540000					90	1				06	201012
14	00540100150181P002		0	0				004		Väilpelto	19760000					42		42			07	200205
15	00540100170034A003		6992804	339936	A		205012	003		Jousilampi	19931201	5	1	5		257	2	257	760		08	200908
16	00540100490011Y001		6999721	346055	A		207017	004		Saarenpää	19550000					75	2				06	200908
17	00540100520010N003		0	0				004		Takala	19910000							56			07	200011
18	00540100610003N001		6989495	338721			101002	001		Kotila	19270000			1		56	2				07	200410
19	00540100610003N002		6989492	338722	B			001		Kotila	19260000							20			07	200410
20	00540200010282R001		6993582	331364			201003	008		Pelloniemi	19500000					52	1				06	200810
21	00540200030131K001		6989239	334866	6		201001	007		Vihersaari	19200000					30	1				07	201103
22	00540200030168H001		6989556	333559			201002	007		Hautala	19530000			1		104	2				07	200108
23	00540400040021H001		6994957	350798			208020	005		Huvila	19420000					70	1				07	201103
24	00540400050062D001		6992460	361611			209022	005		Hornesluhta	19590000					52	1				08	200210
25	00540400050062D001		6992460	361611			208021	005		Takala	19830801	5	2	5		14	1	14	40		07	201212
26	00540400050062D001		6992460	361611			101002	009		Mäkipelto	19530000					45	1				08	201204
27	00541300080072J001		6971756	344924	A			009		Keskisaari	19340000							41			09	200511
28	00541300230006A001		6980324	347023	B			009		Pesäpöntö	19660000							42			07	201209
29	00541400010076Z001		6985160	347316	A			009		Sum	19660000										07	201301
30	00541400070102C002		6968226	348007	B		102005	009				5				20	1				07	201301
31	00541400080137J001		6963302	347249			102006	009		Sahantontti	19200000			1		90	1				09	201302
32	00640300010034H001		6772953	278885	5		1	008		Alaranta	19260000					64	1				06	200406
33	00641900040004B008		6777679	277560			2	008		Pajunen											07	200701
34	00940100010043K001		7119066	366759			101001	001		Palosaari	18000000			1		126	2				06	201109
35	00940100010043K002		7119045	366757			101001	001		Palosaari	19780000					190					06	201109
36	00940100030055A001		7117936	367687	B		101001	001		Katteenhaka	19160000					30	1				07	200506
37	00940100030098H001		7117041	367438	5		101001	001		Kettu	19871001	5	1	5		208	1	208	1030		07	201304
38	00940100070151T001		7117842	367856	5		101001	001		Koveri	19140000					48	1				09	200203
39	00940100040024X001		7119482	368601	B		101001	001		Korhonen	19670000			1		26	1				07	200507
40	00940100040145L002		7118641	368114	5		101001	001		Juttilanranta	19390000					80	2				07	200507
41	00940100050097N002		7118915	368667	5		101001	001		Yrjölä	19300000					30	1				07	200203
42	00940100060091L001		7119171	368339	5		101001	001		Isko	19490000			1		85	2				06	200803
43	00940100070033R001		7118857	368825	5		101001	001		Riheiä	19460000					90	2				07	201201
44	00940100070033R003		7118869	368859			101001	001		Riheiä	19430000										07	201209
45	00940100070033R005		7118945	368669	5		101001	001		Riheiä	19500000										07	200203
46	00940100070046S002		7119231	368972	5		101001	001		Lapinkangas	18000000					70	1				07	200401
47	00940100070046S001		7118399	368984	B		101001	001		Pöytärinta	19300000					45	1				07	200507
48	00940100100042R001		7118397	374782	5		105007	001		Mäkelänneva	19600000										07	200407
49	00940100110021N001		7119991	369866	5		101001	001		Haaparanta	19530000			1		84	2				06	200402
50	00940100110021N002		0	0				001		Haaparanta	19540000					16			16		06	200104
51	00940100110040R001		7119892	369928	B		101002	001		Järvinranta	19200000					105	1				06	200711
52	00940100150063H001		7118523	370813	B		101001	001		Ollintalo	19600000			1		90	1				07	201012

1 rakennus 3 osoite 4 omistaja 5 huoneisto Saate

Normaali näkymä Valmis

Summa=0 VIER ISOT NUM



Processed format = GIS map

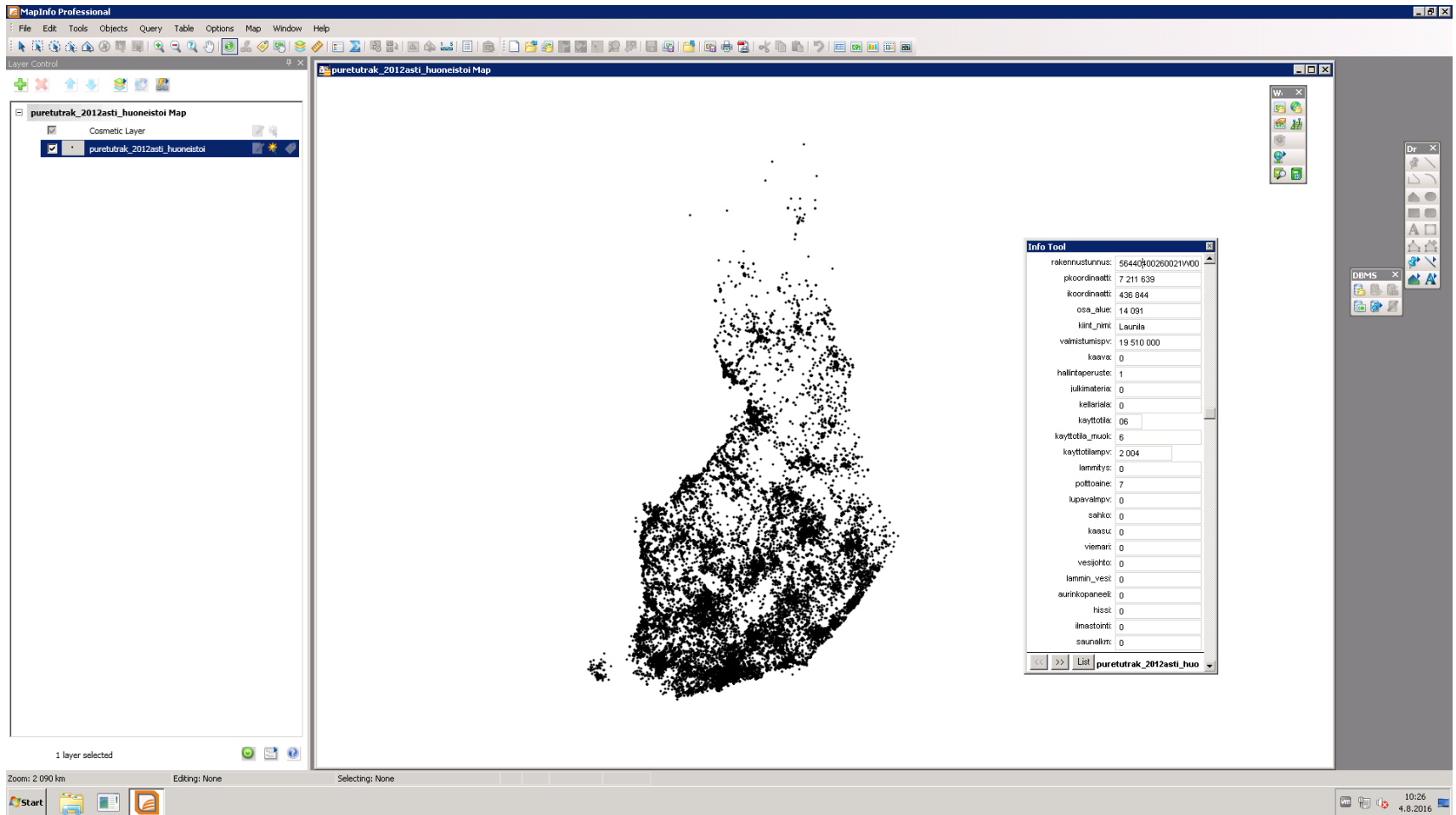

Building-level variables

Field	Specifications
Building identification code	
Coordinate zone	
North coordinate	
East coordinate	
Precision of coordinates	
Map leaf	
Neighbourhood	
Voting area	
Other identification number	
Name of estate	
Parcel	yes / no
Construction date	
Existence of urban plan	detailed plan / shore plan / master plan / no plan
Tenure type	owned / rented
Main facade material	concrete / bricks / metal / stone / wood / glass / other
Floor area	
Number of floors	
Brutto area	
Volume	
Basement area	
State of usage	permanent residence business premises holiday residence other temporary residence vacant demolished due to new construction demolished for other reasons destroyed abandoned due to decay unknown other
State of usage registration date	
Building type	(see Appendix I)
Heat distribution method	hot-water heating / warm-air heating / electric heating / fireplace / no heating
Heat source or fuel type	district heating / light fuel oil / heavy fuel oil / electricity / gas / coal / wood / peat / geothermal / other
Last building permit completion date	
Construction material	concrete / bricks / steel / wood / other
Construction method	prefabricated / in situ built
Electricity	yes / no / not known
Gas	yes / no / not known
Sewer	yes / no / not known

Water supply	yes / no / not known
Warm water	yes / no / not known
Solar panels	yes / no / not known
Elevator	yes / no / not known
Ventilation	yes / no / not known
Number of saunas	
Number of pools	
Capacity of bomb shelters	
Connection to sewer network	yes / no / not known
Connection to fresh water network	yes / no / not known
Connection to electric grid	yes / no / not known
Connection to gas network	yes / no / not known
Connection to cable television network	yes / no / not known
Reason for deviation permit	
Floor area, residential spaces	
Floor area, nursing spaces	
Floor area, assembly spaces	
Floor area, other spaces	
Floor area, shop spaces	
Floor area, educational spaces	
Floor area, office spaces	
Floor area, production spaces	
Floor area, warehouse spaces	
Renovation date	
Last registration date	
Number of homes	
Number of business premises	
Area of business premises	
Funding source, new construction	state-subsidized / municipality-subsidized / not subsidized or unknown
Funding source, renovation	state-subsidized / municipality-subsidized / not subsidized or unknown
Date of issue, new construction loan	
Date of issue, renovation loan	
State-subsidization of housing	state-subsidized rental housing / state-subsidized right of occupancy housing / previously but no longer subsidized / not known
Previous building identification code	

Source: Västörrekisterikeskus, 2011



Building-level variables

Field	Specifications
Building identification code	
Coordinate zone	
North coordinate	
East coordinate	
Precision of coordinates	
Map leaf	
Neighbourhood	
Voting area	
Other identification number	
Name of estate	
Parcel	yes / no
Construction date	
Existence of urban plan	detailed plan / shore plan / master plan / no plan
Tenure type	owned / rented
Main facade material	concrete / bricks / metal / stone / wood / glass / other
Floor area	
Number of floors	
Brutto area	
Volume	
Basement area	
State of usage	permanent residence business premises holiday residence other temporary residence vacant demolished due to new construction demolished for other reasons destroyed abandoned due to decay unknown other
State of usage registration date	
Building type	(see Appendix I)
Heat distribution method	hot-water heating / warm-air heating / electric heating / fireplace / no heating
Heat source or fuel type	district heating / light fuel oil / heavy fuel oil / electricity / gas / coal / wood / peat / geothermal / other
Last building permit completion date	
Construction material	concrete / bricks / steel / wood / other
Construction method	prefabricated / in situ built
Electricity	yes / no / not known
Gas	yes / no / not known
Sewer	yes / no / not known

Water supply	yes / no / not known
Warm water	yes / no / not known
Solar panels	yes / no / not known
Elevator	yes / no / not known
Ventilation	yes / no / not known
Number of saunas	
Number of pools	
Capacity of bomb shelters	
Connection to sewer network	yes / no / not known
Connection to fresh water network	yes / no / not known
Connection to electric grid	yes / no / not known
Connection to gas network	yes / no / not known
Connection to cable television network	yes / no / not known
Reason for deviation permit	
Floor area, residential spaces	
Floor area, nursing spaces	
Floor area, assembly spaces	
Floor area, other spaces	
Floor area, shop spaces	
Floor area, educational spaces	
Floor area, office spaces	
Floor area, production spaces	
Floor area, warehouse spaces	
Renovation date	
Last registration date	
Number of homes	
Number of business premises	
Area of business premises	
Funding source, new construction	state-subsidized / municipality-subsidized / not subsidized or unknown
Funding source, renovation	state-subsidized / municipality-subsidized / not subsidized or unknown
Date of issue, new construction loan	
Date of issue, renovation loan	
State-subsidization of housing	state-subsidized rental housing / state-subsidized right of occupancy housing / previously but no longer subsidized / not known
Previous building identification code	

Source: Västörrekisterikeskus, 2011



Building-level variables

Field	Specifications
Building identification code	
Coordinate zone	
North coordinate	
East coordinate	
Precision of coordinates	
Map leaf	
Neighbourhood	
Voting area	
Other identification number	
Name of estate	
Parcel	yes / no
Construction date	
Existence of urban plan	detailed plan / shore plan / master plan / no plan
Tenure type	owned / rented
Main facade material	concrete / bricks / metal / stone / wood / glass / other
Floor area	
Number of floors	
Brutto area	
Volume	
Basement area	
State of usage	permanent residence business premises holiday residence other temporary residence vacant demolished due to new construction demolished for other reasons destroyed abandoned due to decay unknown other
State of usage registration date	
Building type	(see Appendix I)
Heat distribution method	hot-water heating / warm-air heating / electric heating / fireplace / no heating
Heat source or fuel type	district heating / light fuel oil / heavy fuel oil / electricity / gas / coal / wood / peat / geothermal / other
Last building permit completion date	
Construction material	concrete / bricks / steel / wood / other
Construction method	prefabricated / in situ built
Electricity	yes / no / not known
Gas	yes / no / not known
Sewer	yes / no / not known

Water supply	yes / no / not known
Warm water	yes / no / not known
Solar panels	yes / no / not known
Elevator	yes / no / not known
Ventilation	yes / no / not known
Number of saunas	
Number of pools	
Capacity of bomb shelters	
Connection to sewer network	yes / no / not known
Connection to fresh water network	yes / no / not known
Connection to electric grid	yes / no / not known
Connection to gas network	yes / no / not known
Connection to cable television network	yes / no / not known
Reason for deviation permit	
Floor area, residential spaces	
Floor area, nursing spaces	
Floor area, assembly spaces	
Floor area, other spaces	
Floor area, shop spaces	
Floor area, educational spaces	
Floor area, office spaces	
Floor area, production spaces	
Floor area, warehouse spaces	
Renovation date	
Last registration date	
Number of homes	
Number of business premises	
Area of business premises	
Funding source, new construction	state-subsidized / municipality-subsidized / not subsidized or unknown
Funding source, renovation	state-subsidized / municipality-subsidized / not subsidized or unknown
Date of issue, new construction loan	
Date of issue, renovation loan	
State-subsidization of housing	state-subsidized rental housing / state-subsidized right of occupancy housing / previously but no longer subsidized / not known
Previous building identification code	

Source: Västörrekisterikeskus, 2011



Building types (76 types)

Building type
One dwelling houses
Two-dwelling houses
Other detached and semi-detached houses
Row houses
Terraced houses
Balcony-access blocks
Other blocks of flats
Free-time residential buildings
Shopping halls
Shops, department stores and shopping centres
Other wholesale and retail buildings
Hotels etc.
Holiday, rest and recreation homes
Rental holiday cottages and flats
Other hotel buildings
Residences for communities etc.
Other residential buildings for communities
Restaurants and other similar buildings
Office buildings
Rail and bus stations, air and harbour terminals
Vehicle depots and service buildings
Car parks
Communications buildings
Other transport and communications buildings

General hospitals
Other hospitals
Health centres
Specialized health care buildings
Other health care buildings
Old-age homes
Children's homes, reform schools
Nursing homes for the mentally retarded
Other social welfare buildings
Children's day care centres
Social service buildings n.e.c.
Prisons
Theatres, opera houses, concert halls and congress centres
Cinema halls
Libraries and archives
Museums and art galleries
Exhibition halls
Association and club buildings etc.
Churches, chapels, monasteries, convents and prayer houses
Parish halls
Other buildings of religious communities
Indoor ice rinks
Indoor swimming pools
Indoor tennis, squash and badminton courts
Gymnasias and other sports halls
Other buildings for sports and physical exercise
Other assembly buildings
General education buildings
Vocational education buildings
University buildings
Research institute buildings

Educational buildings of organisations, unions, employers etc.
Educational buildings n.e.c.
Power stations
Public utility buildings
Manufacturing plants
Workshops for industry and small-scale industry
Other industrial production buildings
Industrial warehouses
Commercial warehouses
Other warehouses
Fire stations
Civil defence shelters
Other firefighting and rescue service buildings
Cowsheds, pig houses, hen-houses etc.
Animal shelters, harness horse stables, manèges etc.
Grain drying and storage buildings
Greenhouses
Fur farms
Other buildings in agriculture, forestry and fishing
Sauna buildings
Outbuildings
Buildings n.e.c.

Huuhka, S. (2016). Building 'post-growth': Quantifying and characterizing the Finnish Building stock (unpublished)



Building-level variables

Field	Specifications
Building identification code	
Coordinate zone	
North coordinate	
East coordinate	
Precision of coordinates	
Map leaf	
Neighbourhood	
Voting area	
Other identification number	
Name of estate	
Parcel	yes / no
Construction date	
Existence of urban plan	detailed plan / shore plan / master plan / no plan
Tenure type	owned / rented
Main facade material	concrete / bricks / metal / stone / wood / glass / other
Floor area	
Number of floors	
Brutto area	
Volume	
Basement area	
State of usage	permanent residence business premises holiday residence other temporary residence vacant demolished due to new construction demolished for other reasons destroyed abandoned due to decay unknown other
State of usage registration date	
Building type	(see Appendix I)
Heat distribution method	hot-water heating / warm-air heating / electric heating / fireplace / no heating
Heat source or fuel type	district heating / light fuel oil / heavy fuel oil / electricity / gas / coal / wood / peat / geothermal / other
Last building permit completion date	
Construction material	concrete / bricks / steel / wood / other
Construction method	prefabricated / in situ built
Electricity	yes / no / not known
Gas	yes / no / not known
Sewer	yes / no / not known

Water supply	yes / no / not known
Warm water	yes / no / not known
Solar panels	yes / no / not known
Elevator	yes / no / not known
Ventilation	yes / no / not known
Number of saunas	
Number of pools	
Capacity of bomb shelters	
Connection to sewer network	yes / no / not known
Connection to fresh water network	yes / no / not known
Connection to electric grid	yes / no / not known
Connection to gas network	yes / no / not known
Connection to cable television network	yes / no / not known
Reason for deviation permit	
Floor area, residential spaces	
Floor area, nursing spaces	
Floor area, assembly spaces	
Floor area, other spaces	
Floor area, shop spaces	
Floor area, educational spaces	
Floor area, office spaces	
Floor area, production spaces	
Floor area, warehouse spaces	
Renovation date	
Last registration date	
Number of homes	
Number of business premises	
Area of business premises	
Funding source, new construction	state-subsidized / municipality-subsidized / not subsidized or unknown
Funding source, renovation	state-subsidized / municipality-subsidized / not subsidized or unknown
Date of issue, new construction loan	
Date of issue, renovation loan	
State-subsidization of housing	state-subsidized rental housing / state-subsidized right of occupancy housing / previously but no longer subsidized / not known
Previous building identification code	

Source: Västörrekisterikeskus, 2011



Building-level variables

Field	Specifications
Building identification code	
Coordinate zone	
North coordinate	
East coordinate	
Precision of coordinates	
Map leaf	
Neighbourhood	
Voting area	
Other identification number	
Name of estate	
Parcel	yes / no
Construction date	
Existence of urban plan	detailed plan / shore plan / master plan / no plan
Tenure type	owned / rented
Main facade material	concrete / bricks / metal / stone / wood / glass / other
Floor area	
Number of floors	
Brutto area	
Volume	
Basement area	
State of usage	permanent residence business premises holiday residence other temporary residence vacant demolished due to new construction demolished for other reasons destroyed abandoned due to decay unknown other
State of usage registration date	
Building type	(see Appendix I)
Heat distribution method	hot-water heating / warm-air heating / electric heating / fireplace / no heating
Heat source or fuel type	district heating / light fuel oil / heavy fuel oil / electricity / gas / coal / wood / peat / geothermal / other
Last building permit completion date	
Construction material	concrete / bricks / steel / wood / other
Construction method	prefabricated / in situ built
Electricity	yes / no / not known
Gas	yes / no / not known
Sewer	yes / no / not known

Water supply	yes / no / not known
Warm water	yes / no / not known
Solar panels	yes / no / not known
Elevator	yes / no / not known
Ventilation	yes / no / not known
Number of saunas	
Number of pools	
Capacity of bomb shelters	
Connection to sewer network	yes / no / not known
Connection to fresh water network	yes / no / not known
Connection to electric grid	yes / no / not known
Connection to gas network	yes / no / not known
Connection to cable television network	yes / no / not known
Reason for deviation permit	
Floor area, residential spaces	
Floor area, nursing spaces	
Floor area, assembly spaces	
Floor area, other spaces	
Floor area, shop spaces	
Floor area, educational spaces	
Floor area, office spaces	
Floor area, production spaces	
Floor area, warehouse spaces	
Renovation date	
Last registration date	
Number of homes	
Number of business premises	
Area of business premises	
Funding source, new construction	state-subsidized / municipality-subsidized / not subsidized or unknown
Funding source, renovation	state-subsidized / municipality-subsidized / not subsidized or unknown
Date of issue, new construction loan	
Date of issue, renovation loan	
State-subsidization of housing	state-subsidized rental housing / state-subsidized right of occupancy housing / previously but no longer subsidized / not known
Previous building identification code	

Source: Västörrekisterikeskus, 2011



Research objects

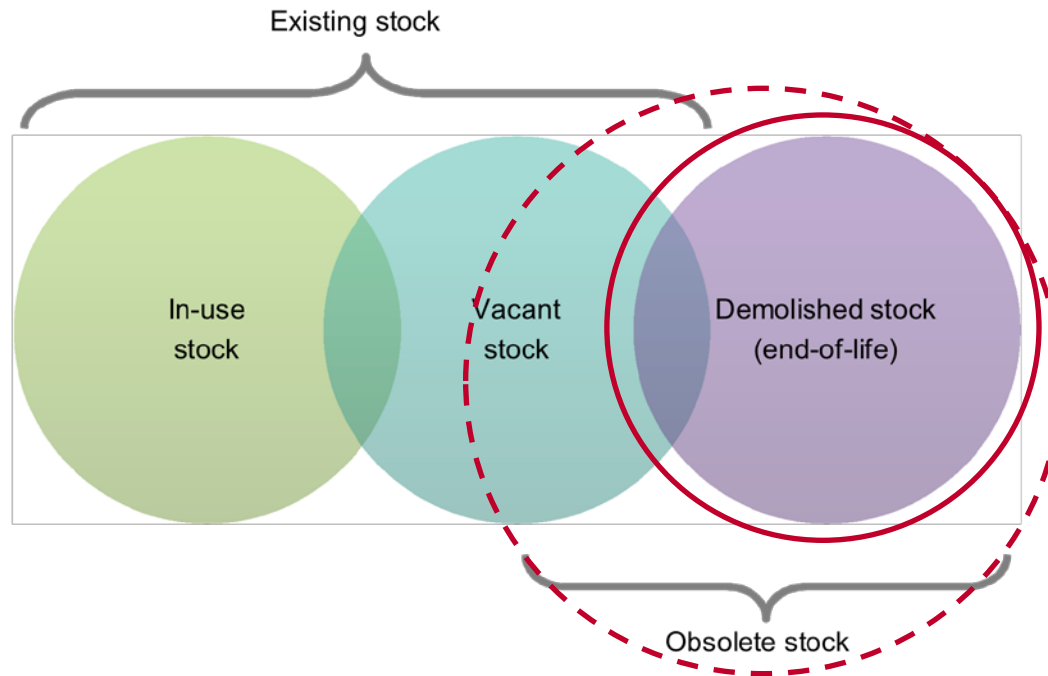
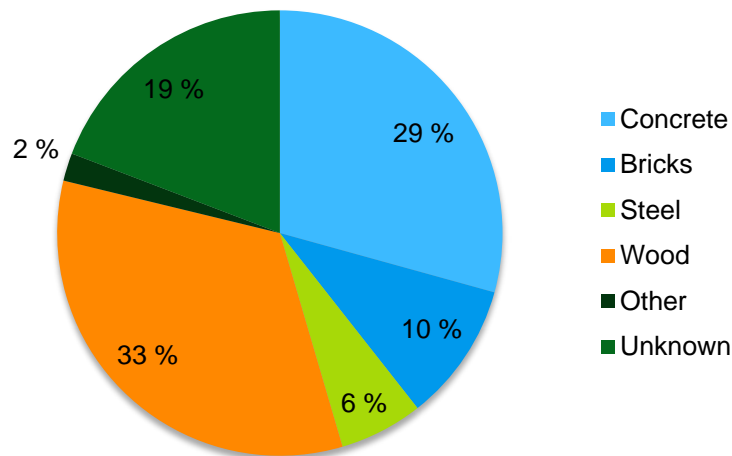

Figure 2. Conceptualization of the composition of the building stock and the relations between different parts thereof.



Demolished buildings: construction materials

Demolished floor area,
construction material



Huuhka, S. & Lahdensivu, J. (2016) Statistical and geographical study on demolished buildings

C&D waste composition,
estimation 2012

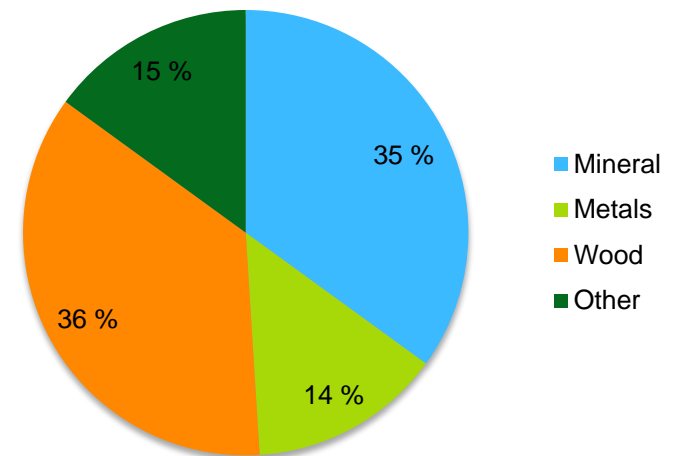

Meinander, M. & Mroueh, U.-M. (2012). Directions of future developments in waste recycling (VTT Technology 60)



Demolished floor area by b. type

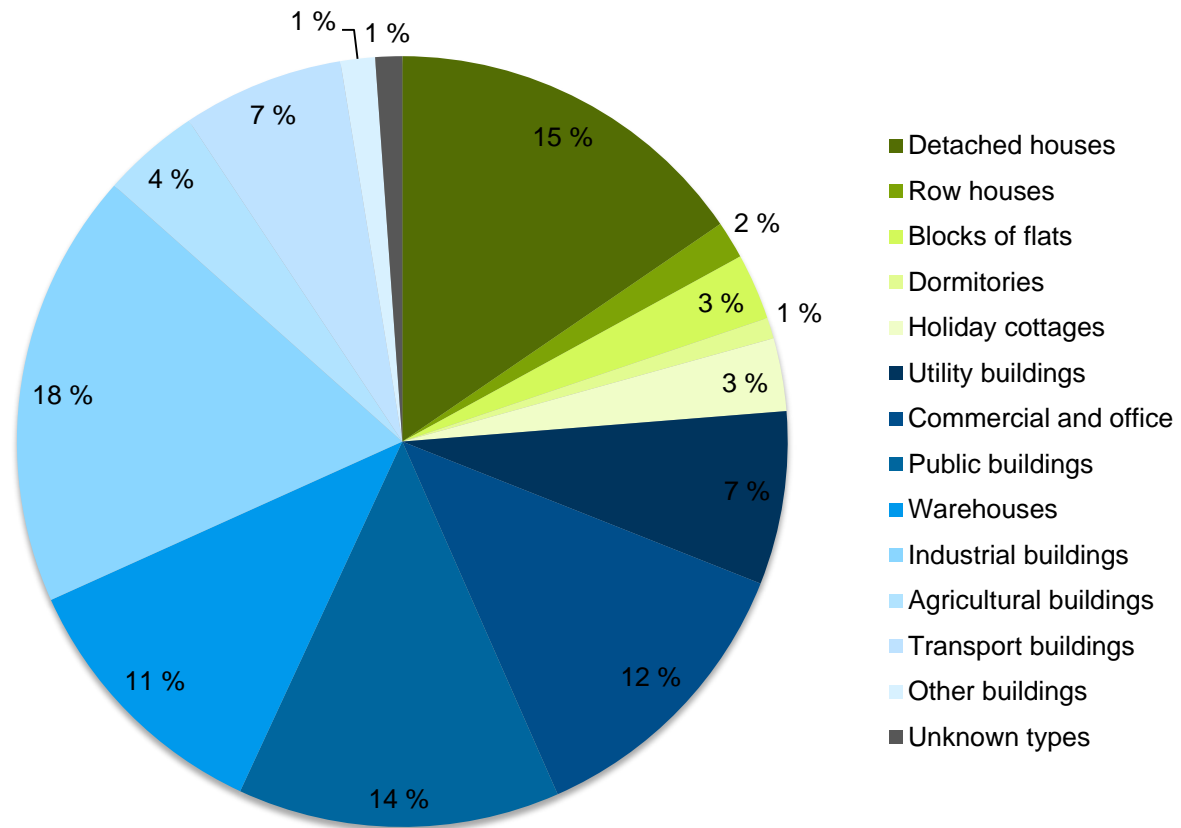

Materials by types



Detached houses

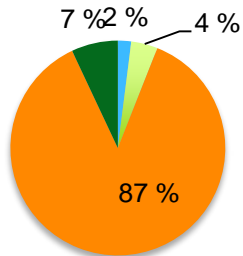

Row houses

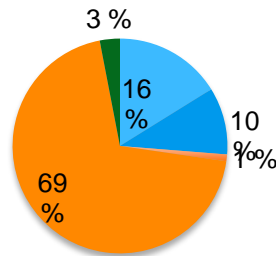

Blocks of flats

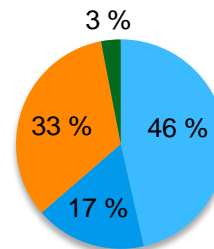

Dormitories

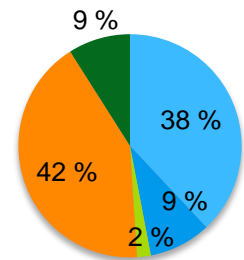

Holiday cottages

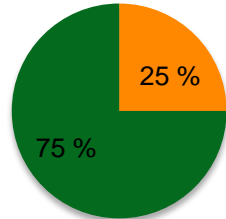

Utility buildings

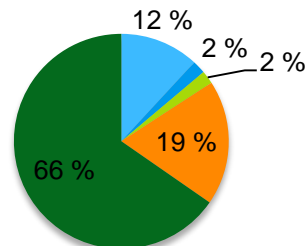

Commercial and office

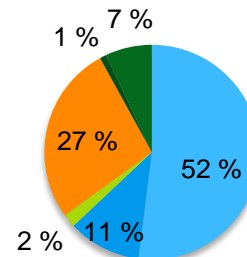

Public buildings

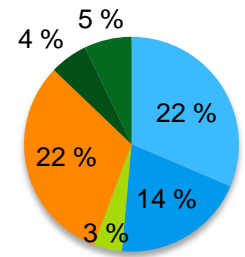

Warehouses

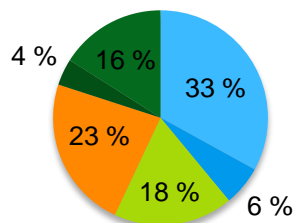

Industrial buildings

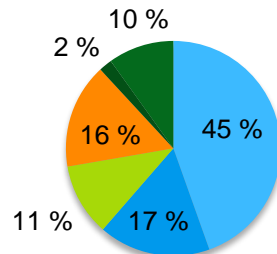

Agricultural buildings

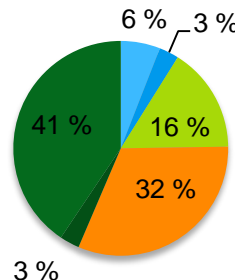

Transport buildings

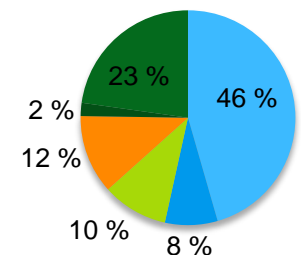

Type & decade → materials

Table 9 Building year by building type

Name of the group number of buildings and % floor area in m ² and %	–1899 (2%)	1900–09 (2%)	1910–19 (2%)	1920–29 (23%)	1930–39 (11%)	1940–49 (19%)	1950–59 (22%)	1960–69 (9%)	1970–79 (6%)	1980–89 (3%)	1990–99 (1%)	2000– (0%)	Total, known records (100%)
Detached houses	351 (2%)	315 (2%)	292 (2%)	3637 (23%)	1803 (11%)	2956 (19%)	3537 (22%)	1510 (9%)	893 (6%)	422 (3%)	145 (1%)	77 (0%)	15 938 (100%)
	32 088 (2%)	27 610 (2%)	26 376 (2%)	275 324 (19%)	138 640 (10%)	248 432 (18%)	315 038 (22%)	162 639 (12%)	103 969 (7%)	53 352 (4%)	20 025 (1%)	10 428 (1%)	1 413 921 (100%)
Terraced (row) houses	3 (1%)	3 (1%)	1 (0%)	33 (9%)	8 (2%)	31 (8%)	25 (7%)	81 (22%)	133 (36%)	41 (11%)	9 (2%)	0 (0%)	368 (100%)
	997 (1%)	669 (0%)	332 (0%)	10 011 (7%)	1 759 (1%)	10 402 (7%)	7392 (5%)	42 483 (29%)	55 752 (38%)	13 651 (9%)	3153 (2%)	0 (0%)	146 601 (100%)
Blocks of flats	8 (2%)	7 (1%)	9 (2%)	106 (22%)	66 (14%)	101 (21%)	86 (18%)	47 (10%)	39 (8%)	14 (3%)	1 (0%)	0 (0%)	484 (100%)
	2485 (1%)	1924 (1%)	1928 (1%)	24 806 (10%)	17 877 (7%)	30 115 (21%)	52 287 (20%)	51 001 (23%)	58 555 (23%)	13 161 (5%)	337 (0%)	0 (0%)	254 476 (100%)
Dormitories	18 (8%)	0 (0%)	1 (0%)	8 (3%)	9 (4%)	19 (8%)	9 (4%)	25 (10%)	66 (28%)	55 (23%)	20 (9%)	5 (2%)	235 (100%)
	5155 (6%)	0 (0%)	477 (1%)	1771 (2%)	2396 (3%)	5041 (6%)	10 502 (13%)	8374 (10%)	22 625 (28%)	12 698 (15%)	11 576 (14%)	1533 (2%)	82 148 (100%)
Holiday cottages	26 (0%)	47 (1%)	33 (0%)	520 (7%)	416 (6%)	664 (10%)	1426 (21%)	1496 (22%)	1286 (19%)	657 (9%)	285 (4%)	89 (1%)	6945 (100%)
	1651 (1%)	2715 (1%)	1974 (1%)	27 939 (10%)	17 589 (7%)	26 485 (20%)	49 651 (20%)	52 375 (20%)	46 455 (17%)	24 398 (9%)	11 187 (4%)	4239 (2%)	266 658 (100%)
Utility buildings	141 (1%)	296 (2%)	192 (1%)	837 (6%)	1028 (7%)	1797 (13%)	2557 (18%)	1536 (11%)	2532 (18%)	1528 (11%)	985 (7%)	401 (3%)	13 830 (100%)
	7049 (1%)	11 797 (2%)	7940 (1%)	39 174 (6%)	41 395 (7%)	73 456 (12%)	100 550 (16%)	117 800 (19%)	109 242 (18%)	60 439 (10%)	32 329 (5%)	13 850 (2%)	615 021 (100%)
Commercial and office buildings	9 (0%)	12 (1%)	10 (0%)	111 (5%)	91 (4%)	112 (5%)	222 (11%)	379 (18%)	459 (22%)	469 (22%)	187 (9%)	53 (3%)	2114 (100%)
	2269 (0%)	6360 (1%)	1564 (0%)	34 468 (3%)	52 191 (5%)	72 343 (6%)	121 404 (11%)	245 845 (22%)	400 537 (35%)	115 713 (10%)	56 925 (5%)	18 685 (2%)	1 128 304 (100%)
Public buildings	10 (1%)	10 (1%)	11 (1%)	76 (7%)	48 (5%)	70 (7%)	123 (12%)	166 (16%)	188 (18%)	181 (17%)	83 (8%)	77 (7%)	1 043 (100%)
	3554 (0%)	2106 (0%)	3723 (0%)	31 321 (4%)	26 676 (3%)	79 253 (9%)	136 304 (16%)	199 211 (23%)	162 569 (19%)	127 116 (15%)	63 553 (7%)	35 634 (4%)	871 020 (100%)
Warehouses	4 (0%)	15 (1%)	12 (1%)	63 (5%)	63 (5%)	92 (7%)	163 (12%)	170 (12%)	257 (19%)	303 (22%)	169 (12%)	67 (5%)	1 378 (100%)

(Table continued)



Type & decade → materials

Table 9 Building year by building type

Name of the group number of buildings and % floor area in m ² and %	–1899 (2%)	1900–09 (2%)	1910–19 (2%)	1920–29 (23%)	1930–39 (11%)	1940–49 (19%)	1950–59 (22%)	1960–69 (9%)	1970–79 (6%)	1980–89 (3%)	1990–99 (1%)	2000– (0%)	Total, known records (100%)
Detached houses	351 (2%)	315 (2%)	292 (2%)	3637 (23%)	1803 (11%)	2956 (19%)	3537 (22%)	1510 (9%)	893 (6%)	422 (3%)	145 (1%)	77 (0%)	15 938 (100%)
	32 088 (2%)	27 610 (2%)	26 376 (2%)	275 324 (19%)	138 640 (10%)	248 432 (18%)	315 038 (22%)	162 639 (12%)	103 969 (7%)	53 352 (4%)	20 025 (1%)	10 428 (1%)	1 413 921 (100%)
Terraced (row) houses	3 (1%)	3 (1%)	1 (0%)	33 (9%)	8 (2%)	31 (8%)	25 (7%)	81 (22%)	133 (36%)	41 (11%)	9 (2%)	0 (0%)	368 (100%)
	997 (1%)	669 (0%)	332 (0%)	10 011 (7%)	1 759 (1%)	10 402 (7%)	7392 (5%)	42 483 (29%)	55 752 (38%)	13 651 (9%)	3153 (2%)	0 (0%)	146 601 (100%)
Blocks of flats	8 (2%)	7 (1%)	9 (2%)	106 (22%)	66 (14%)	101 (21%)	86 (18%)	47 (10%)	39 (8%)	14 (3%)	1 (0%)	0 (0%)	484 (100%)
	2485 (1%)	1924 (1%)	1928 (1%)	24 806 (10%)	17 877 (7%)	30 115 (12%)	52 287 (21%)	51 001 (20%)	58 555 (23%)	13 161 (5%)	337 (0%)	0 (0%)	254 476 (100%)
Dormitories	18 (8%)	0 (0%)	1 (0%)	8 (3%)	9 (4%)	19 (8%)	9 (4%)	25 (10%)	66 (28%)	55 (23%)	20 (9%)	5 (2%)	235 (100%)
	5155 (6%)	0 (0%)	477 (1%)	1771 (2%)	2396 (3%)	5041 (6%)	10 502 (13%)	8374 (10%)	22 625 (28%)	12 698 (15%)	11 576 (14%)	1533 (2%)	82 148 (100%)
Holiday cottages	26 (0%)	47 (1%)	33 (0%)	520 (7%)	416 (6%)	664 (10%)	1426 (21%)	1496 (22%)	1286 (19%)	657 (9%)	285 (4%)	89 (1%)	6945 (100%)
	1651 (1%)	2715 (1%)	1974 (1%)	27 939 (10%)	17 589 (7%)	26 485 (10%)	49 651 (20%)	52 375 (20%)	46 455 (17%)	24 398 (9%)	11 187 (4%)	4239 (2%)	266 658 (100%)
Utility buildings	141 (1%)	296 (2%)	192 (1%)	837 (6%)	1028 (7%)	1797 (13%)	2557 (18%)	1536 (11%)	2532 (18%)	1528 (11%)	985 (7%)	401 (3%)	13 830 (100%)
	7049 (1%)	11 797 (2%)	7940 (1%)	39 174 (6%)	41 395 (7%)	73 456 (12%)	100 550 (16%)	117 800 (19%)	109 242 (18%)	60 439 (10%)	32 329 (5%)	13 850 (2%)	615 021 (100%)
Commercial and office buildings	9 (0%)	12 (1%)	10 (0%)	111 (5%)	91 (4%)	112 (5%)	222 (11%)	379 (18%)	459 (22%)	469 (22%)	187 (9%)	53 (3%)	2114 (100%)
	2269 (0%)	6360 (1%)	1564 (0%)	34 468 (3%)	52 191 (5%)	72 343 (6%)	121 404 (11%)	245 845 (22%)	400 537 (35%)	115 713 (10%)	56 925 (5%)	18 685 (2%)	1 128 304 (100%)
Public buildings	10 (1%)	10 (1%)	11 (1%)	76 (7%)	48 (5%)	70 (7%)	123 (12%)	166 (16%)	188 (18%)	181 (17%)	83 (8%)	77 (7%)	1 043 (100%)
	3554 (0%)	2106 (0%)	3723 (0%)	31 321 (4%)	26 676 (3%)	79 253 (9%)	136 304 (16%)	199 211 (23%)	162 569 (19%)	127 116 (15%)	63 553 (7%)	35 634 (4%)	871 020 (100%)
Warehouses	4 (0%)	15 (1%)	12 (1%)	63 (5%)	63 (5%)	92 (7%)	163 (12%)	170 (12%)	257 (19%)	303 (22%)	169 (12%)	67 (5%)	1 378 (100%)

(Table continued)



Age-use cohort: Component composition

Part of building or component	Average or typical value
Prefabricated façade	12 040 m ² or 4300 m*
load-bearing	3360 m ² or 1200 m*
non-load-bearing	8680 m ² or 3100 m*
Façade panels	129 pieces
load-bearing	46 pieces
non-load-bearing	83 pieces
Different panels	3–6 types
load-bearing	1–2 types
non-load-bearing	2–4 types
Prefabricated floor	1410 m ² or 1175 m**
Prefabricated floor slabs	180 pieces

Table 4. Typical values in the age cohort (Article III).

Notes: *) 2.8 m high panels; **) 1.2 m wide slabs.

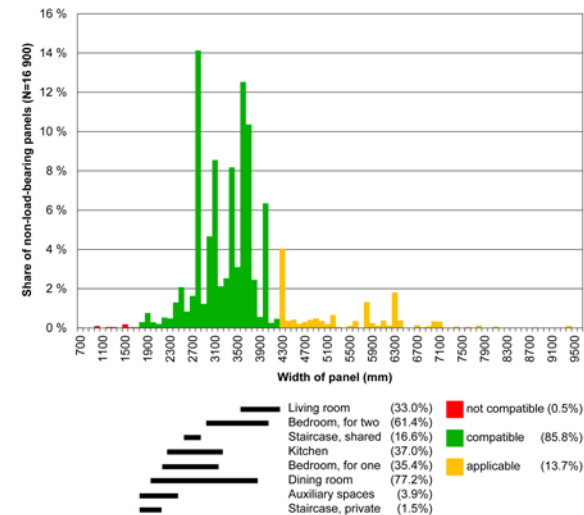
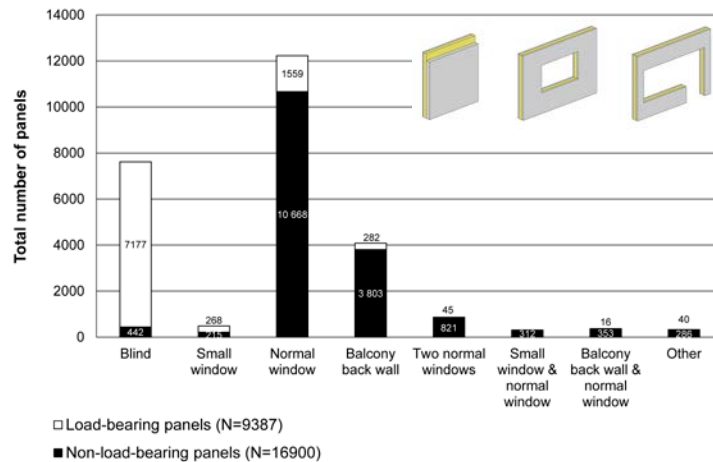
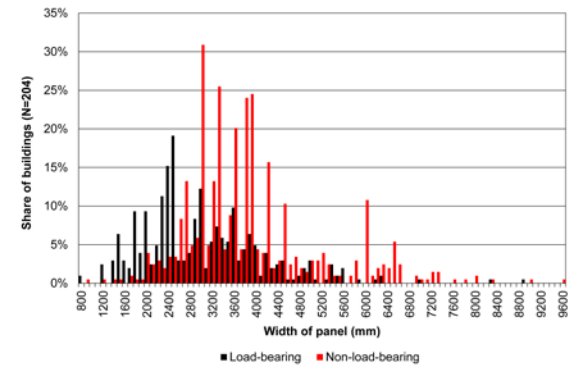

Age-use cohort: Spatial composition

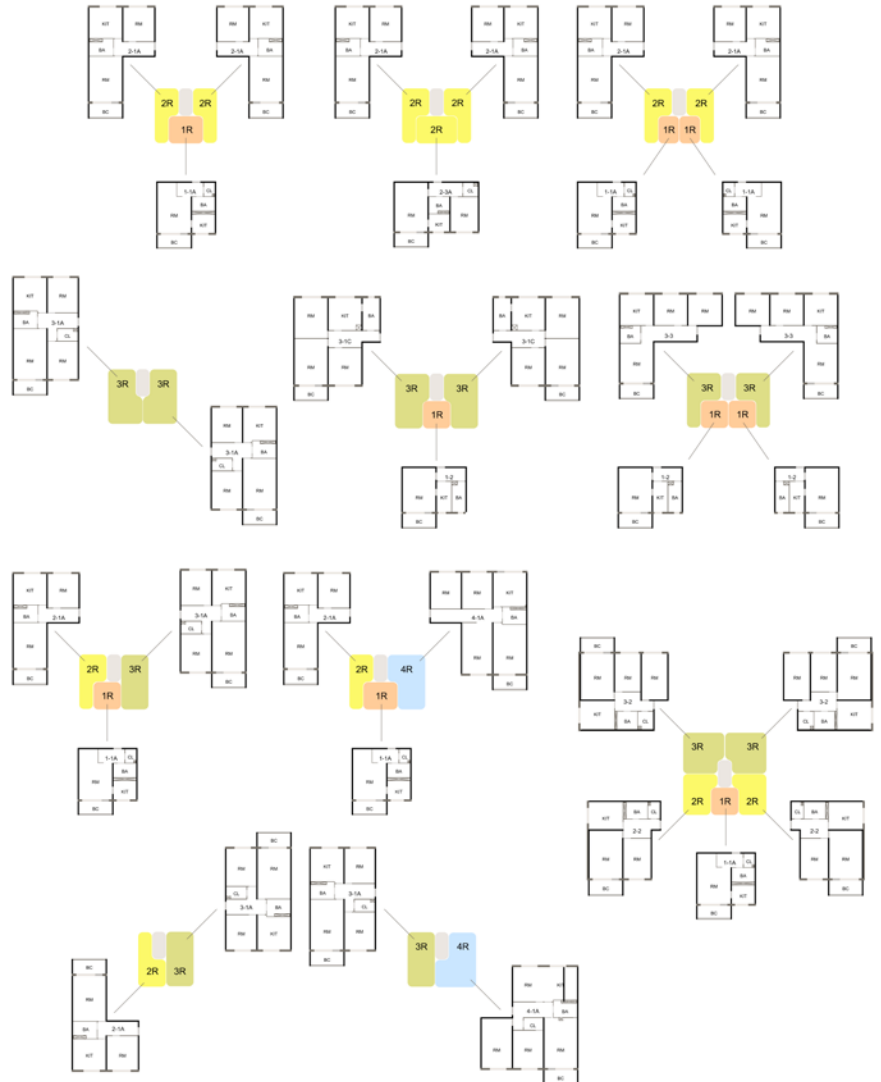

Kaasalainen, T. & Huuhka, S. (2016) Homogenous homes of Finland:
'Standard' flats in non-standardized blocks

Huuhka, S. (2016). Building 'post-growth':
Quantifying and characterizing the Finnish Building
stock (unpublished)



Dynamics of the stock

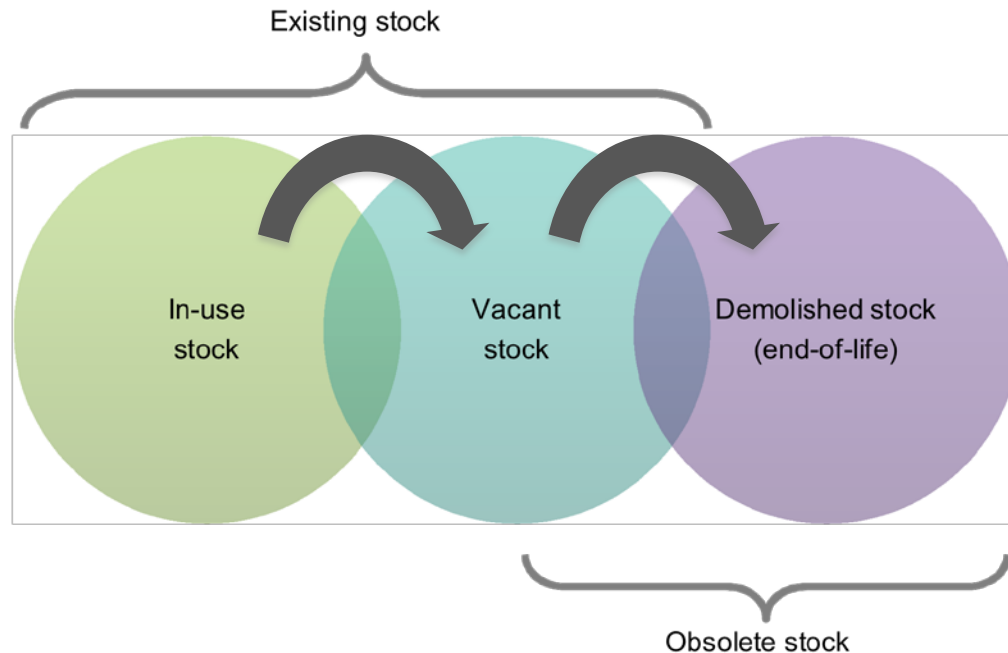
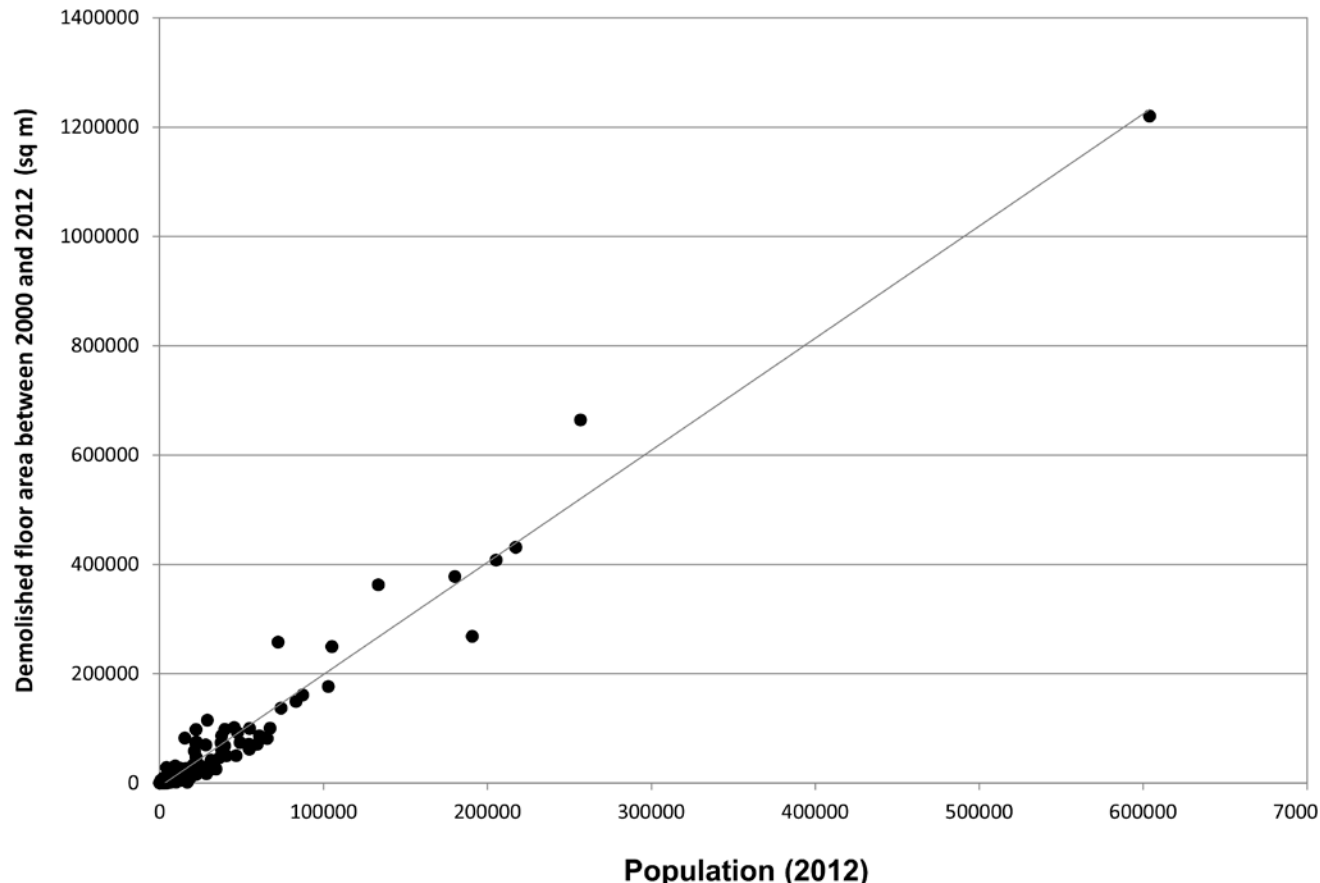

Figure 2. Conceptualization of the composition of the building stock and the relations between different parts thereof.



Correlation and regression analysis

a) population + demolished floor area



Correlation and regression analysis

e) population + vacant homes

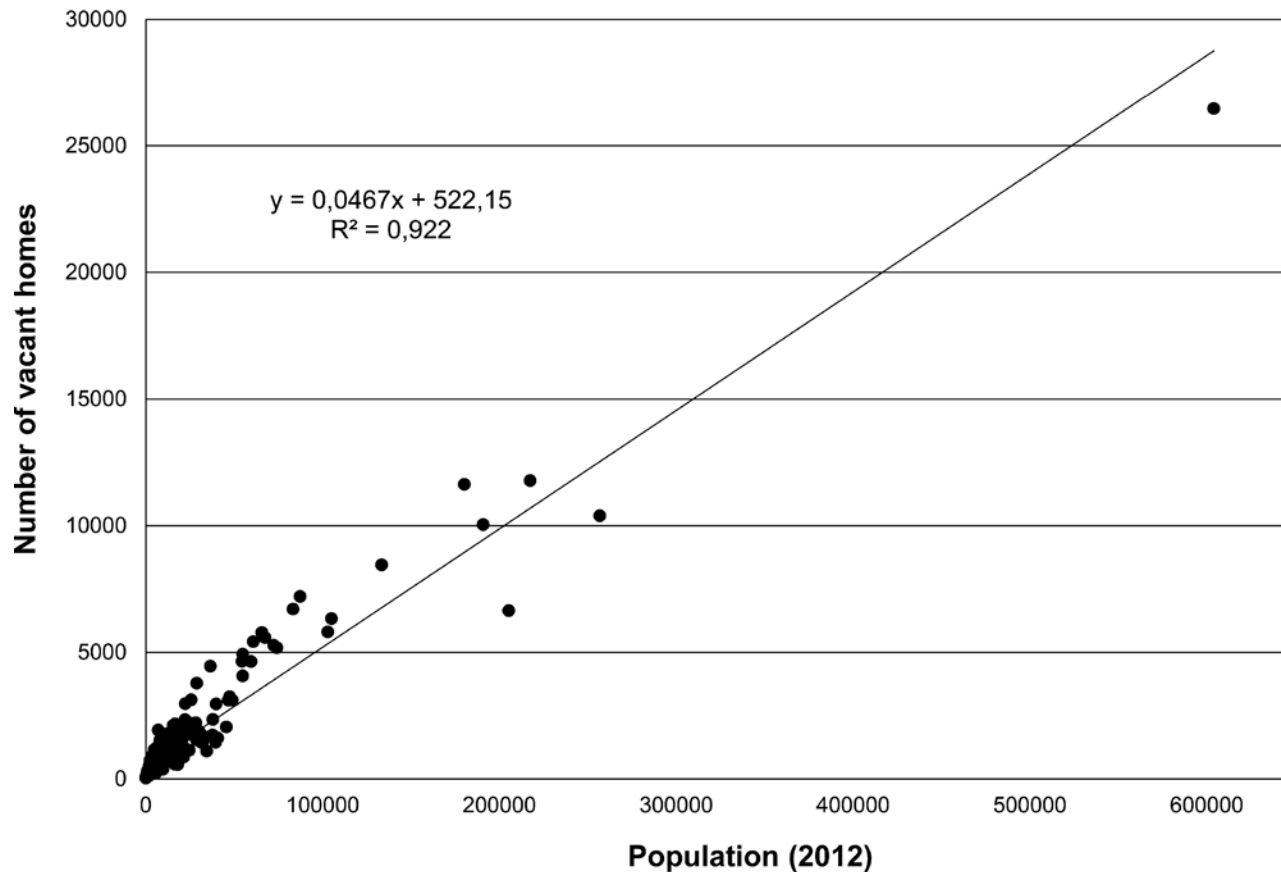

Correlation and regression analysis

b) population change rate + vacancy rate

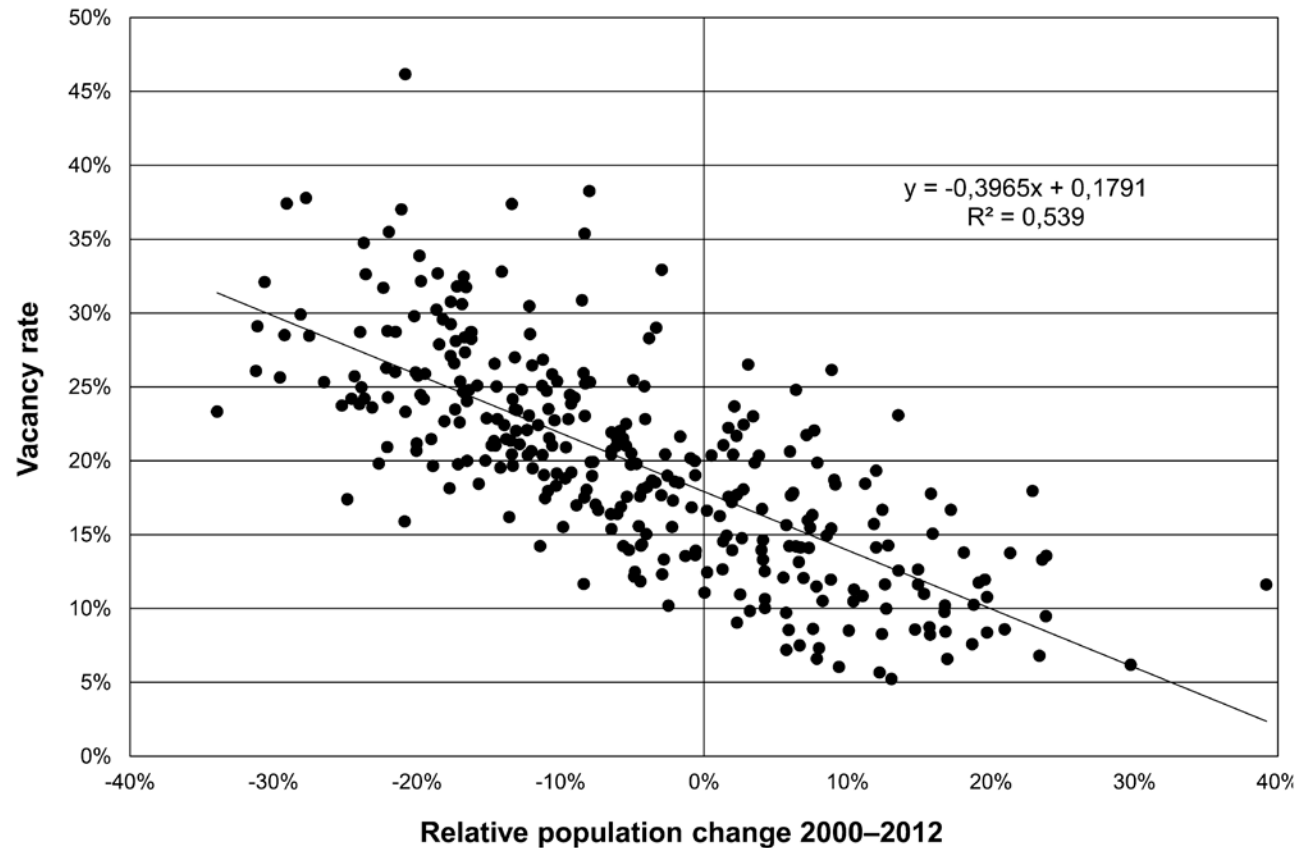

Correlation and regression analysis

h) demolition rate of homes + vacancy rate

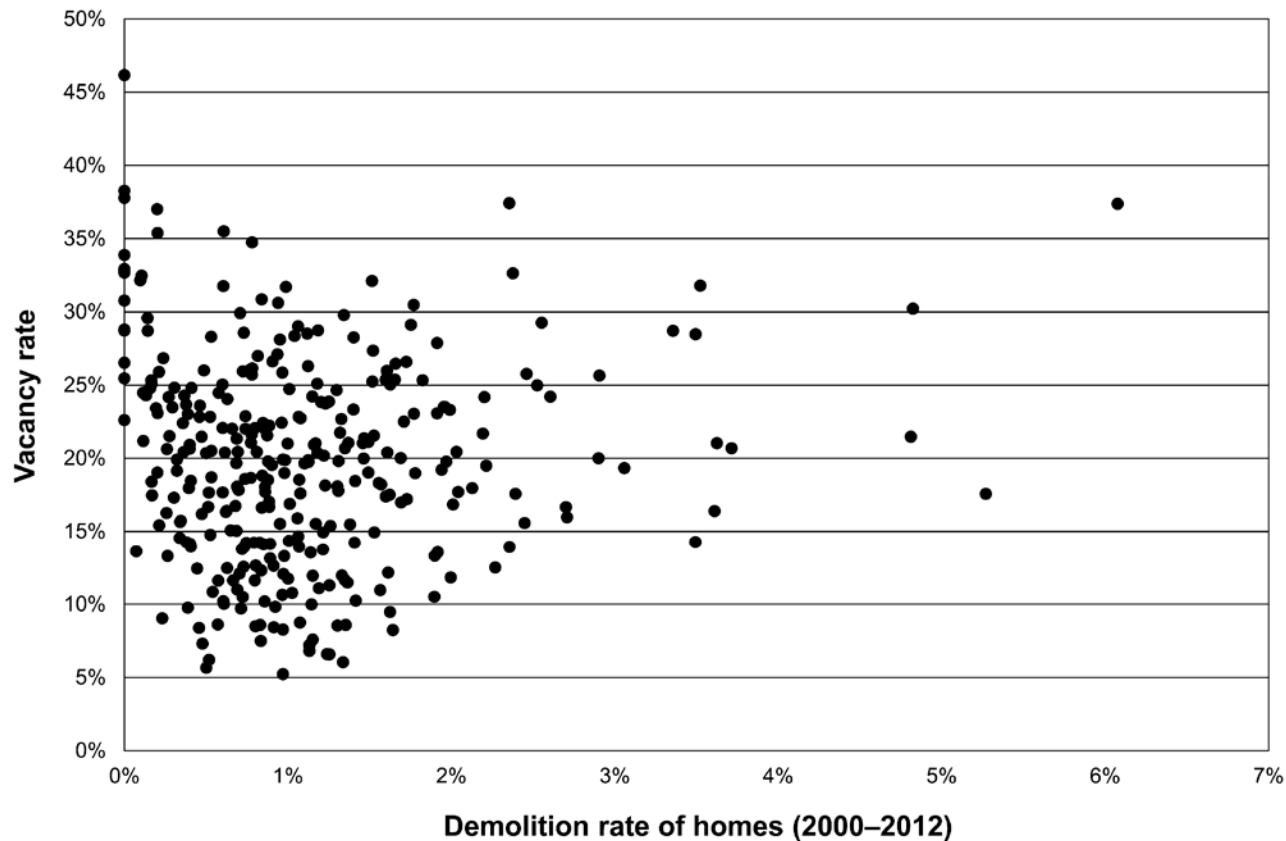



Thank you
for your attention!